

**Property Maps**  
for the  
**Condamine and Balonne Tributaries**  
**Water Management Area**

## Property Maps for the Condamine and Balonne Tributaries Water Management Area

### CONTENTS



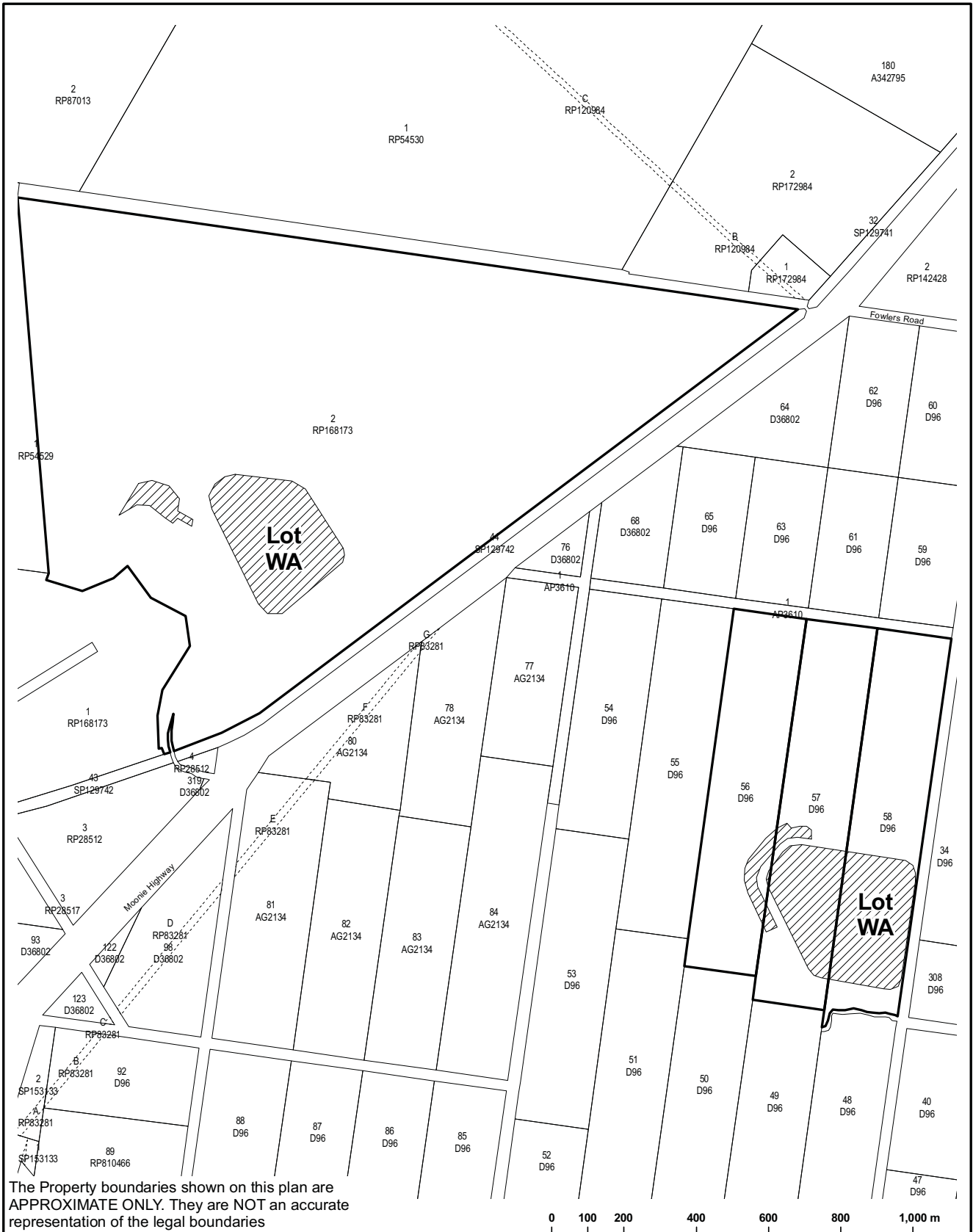

WA 294	(AP 18762)	141
WA 433	(AP 18757)	142
WA 437	(AP 18790)	143
WA 438	(AP 18790)	143
WA 439	(AP 18790)	143
WA 440	(AP 18791)	144
WA 441	(AP 18774)	145
WA 445	(AP 18773)	146
WA 450	(AP 18801)	147
WA 452	(AP 18784)	148
WA 454	(AP 18786)	149
WA 455	(AP 18782)	150
WA 456	(AP 18760)	151
WA 457	(AP 18771)	152
WA 458	(AP 18785)	153
WA 459	(AP 18789)	154
WA 460	(AP 18778)	155
WA 461	(AP 18796)	156
WA 463	(AP 18787)	157
WA 464	(AP 18795)	158
WA 466	(AP 18802)	159
WA 468	(AP 18776)	160
WA 469	(AP 18775)	161
WA 470	(AP 18775)	161
WA 471	(AP 18775)	161
WA 472	(AP 18764)	162
WA 473	(AP 18777)	163
WA 475	(AP 18763)	164
WA 480	(AP 18759)	165
WA 482	(AP 18800)	166
WA 483	(AP 18767)	167
WA 485	(AP 18792)	168
WA 486	(AP 18792)	168
WA 487	(AP 18783)	169
WA 489	(AP 18779)	170
WA 491	(AP 18766)	171
WA 493	(AP 18780)	172
WA 495	(AP 18765)	173
WA 496	(AP 18788)	174
WA 497	(AP 18798)	175
WA 498	(AP 18758)	176
WA 499	(AP 18803)	177
WA 500	(AP 18769)	178
WA 501	(AP 18770)	179
WA 504	(AP 18793)	180
WA 506	(AP 18793)	180

WA 507	(AP 18768)	181
WA 508	(AP 18799)	182
WA 509	(AP 18794)	183
WA 512	(AP 18781)	184
WA 517	(AP 18761)	185
WA 518	(AP 18761)	185
WA 519	(AP 18772)	186
WA 520	(AP 18797)	187
WA 1679	(AP 18783)	180

# Condamine and Balonne Tributaries Water Management Area



The Property boundaries shown on this plan are APPROXIMATE ONLY. They are NOT an accurate representation of the legal boundaries

<p><b>LEGEND</b></p> <p> Waterharvesting Storage/s</p> <p> Parcels containing Storage/s</p>	<p><b>Plan of Lot WA - abt 24 ha</b></p> <p><i>in Lots 56, 57 &amp; 58 on D96 and Lot 2 on RP168173</i></p>	
<p><b>Scale 1:10,000</b> at original size (A3)</p> <p> <b>NORTH</b></p>	<p><b>PARISH:</b> MYALL <b>COUNTY:</b> AUBIGNY</p> <p><b>REGION:</b> SOUTH WEST</p>	<p><b>LOCALITY:</b> DALBY <b>LOCAL AUTHORITY:</b> DALBY REGIONAL</p> <p><b>Map Reference:</b> 9143</p>
<p><b>Prepared By:</b> DWB</p>	<p><b>Date:</b> 25/02/2008</p> <p><b>Compiled from:</b> DCDB (FEBRUARY 2008)</p>	<p><b>AP18762</b></p>

# Condamine and Balonne Tributaries Water Management Area

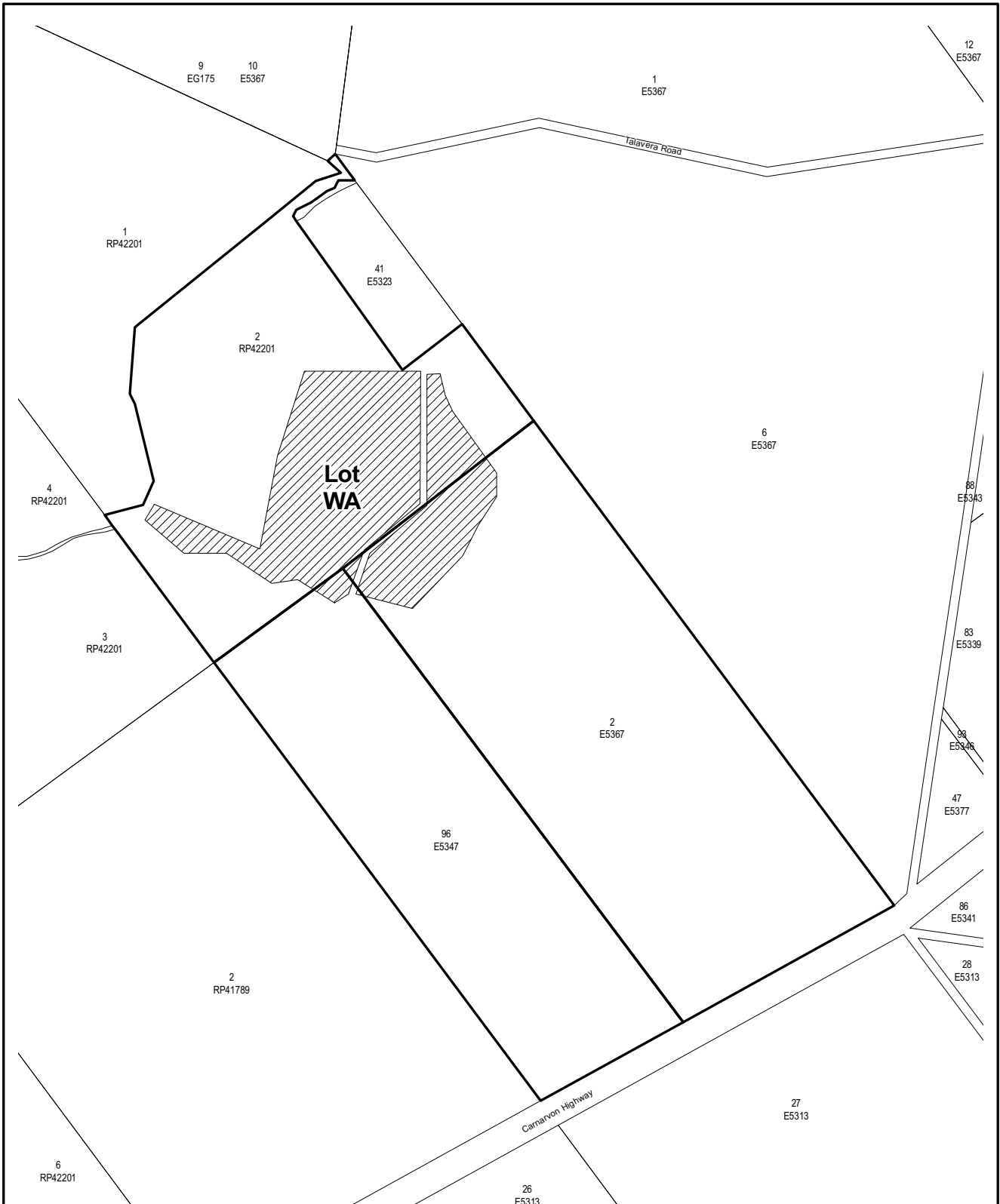

The Property boundaries shown on this plan are APPROXIMATE ONLY. They are NOT an accurate representation of the legal boundaries

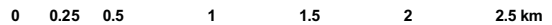





<b>LEGEND</b> Waterharvesting Storage/s Parcels containing Storage/s	<b>Plan of Lot WA - abt 201 ha</b> <i>in Lot 2 on E5367 and Lot 2 on RP42201 and Lot 96 on E5347</i>		<b>Queensland Government</b> Natural Resources and Water
	PARISH: TALAVERA COUNTY: ELGIN	LOCALITY: WELLESLEY LOCAL AUTHORITY: ROMA REGIONAL	
Scale <b>1:25,000</b> at original size (A3)	REGION: SOUTH WEST Prepared By: DWB      Date: 22/02/2008	Map Reference: 8643/8743 Compiled from: DCDB (FEBRUARY 2008)	
<b>NORTH</b>			

# Condamine and Balonne Tributaries Water Management Area



The Property boundaries shown on this plan are APPROXIMATE ONLY. They are NOT an accurate representation of the legal boundaries





0 125 250 500 750 1,000 1,250 1,500 m

<b>LEGEND</b>  Waterharvesting Storage/s  Parcels containing Storage/s	<b>Plan of Lot WA - abt 36 ha</b> <i>in Lot 9 on WAL53317</i>		 <b>Queensland Government</b> Natural Resources and Water
	PARISH: HOPE COUNTY: WALDEGRAVE	LOCALITY: TINGUN LOCAL AUTHORITY: ROMA REGIONAL	
Scale <b>1:15,000</b> at original size (A3)	REGION: SOUTH WEST Prepared By: DWB	Map Reference: 8644 Date: 14/03/2008	
 <b>NORTH</b>	Date: 14/03/2008 Compiled from: DCDB (MARCH 2008)		

Condamine and Balonne Tributaries Water Management Area



The Property boundaries shown on this plan are APPROXIMATE ONLY. They are NOT an accurate representation of the legal boundaries

<b>LEGEND</b>  Waterharvesting Storage/s  Parcels containing Storage/s	<b>Plan of Lot WA - abt 5 ha</b> in Lot 332 on WW1668		 <b>Queensland Government</b> Natural Resources and Water
	PARISH: ROMA COUNTY: WALDEGRAVE	LOCALITY: ROMA LOCAL AUTHORITY: ROMA REGIONAL	
Scale 1:5,000 at original size (A3)	REGION: SOUTH WEST Prepared By: DWB	Map Reference: 8644 Date: 14/03/2008	AP18791
	Compiled from: DCDB (MARCH 2008)		

Condamine and Balonne Tributaries Water Management Area



The Property boundaries shown on this plan are APPROXIMATE ONLY. They are NOT an accurate representation of the legal boundaries

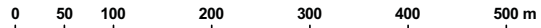

<b>LEGEND</b> Waterharvesting Storage/s Parcels containing Storage/s	<b>Plan of Lot WA - abt 1 ha</b> in Lot 316 on WV125		Queensland Government Natural Resources and Water
	PARISH: EUTHULLA COUNTY: WALDEGRAVE	LOCALITY: ORANGE HILL LOCAL AUTHORITY: ROMA REGIONAL	
Scale 1:5,000 at original size (A3)	REGION: SOUTH WEST Prepared By: DWB	Map Reference: 8645 Date: 03/03/2008	AP18774
NORTH	Date: 03/03/2008	Compiled from: DCDB (MARCH 2008)	

# Condamine and Balonne Tributaries Water Management Area

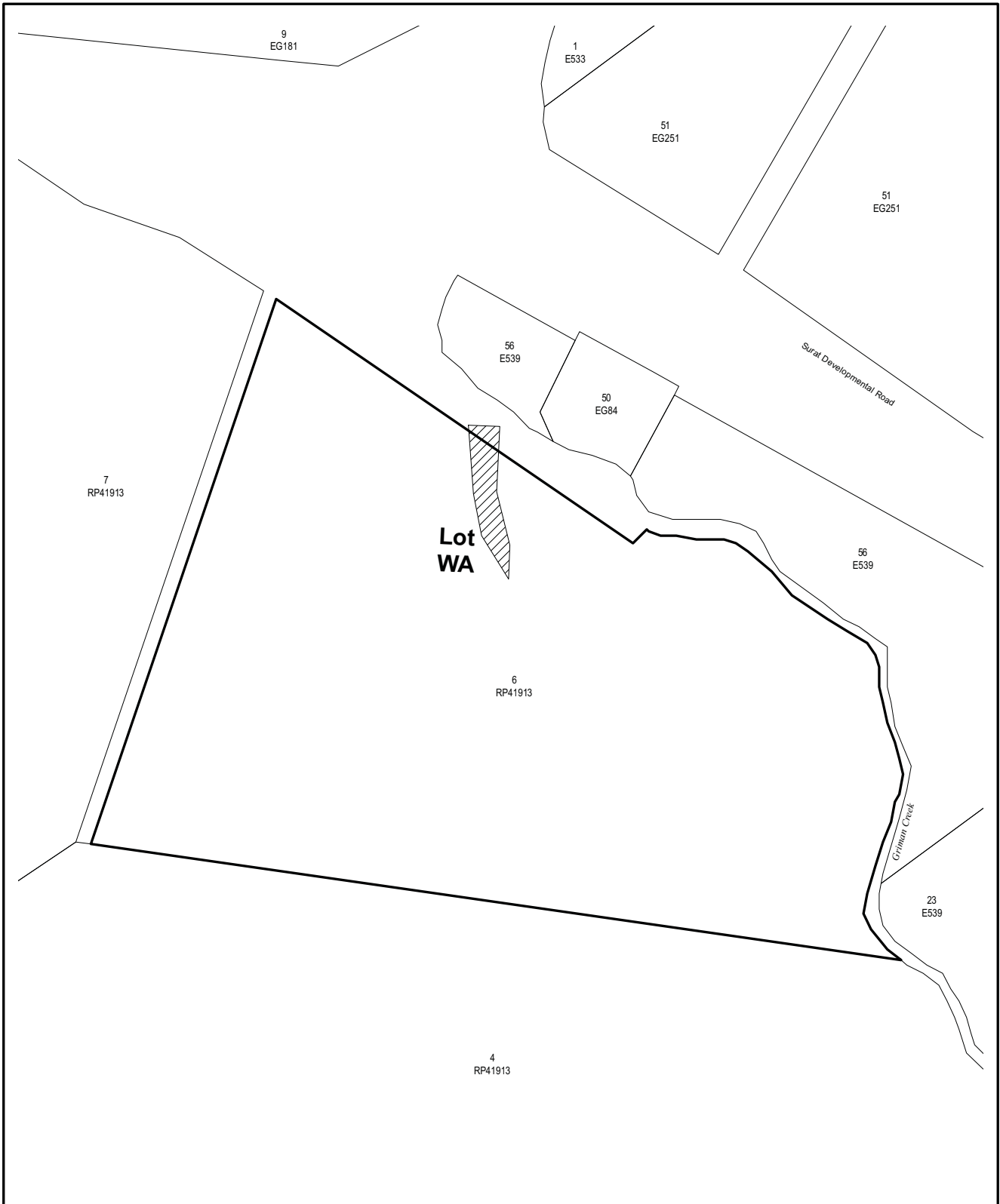

The Property boundaries shown on this plan are APPROXIMATE ONLY. They are NOT an accurate representation of the legal boundaries



<b>LEGEND</b> Waterharvesting Storage/s Parcels containing Storage/s	<b>Plan of Lot WA - abt 1 ha</b> <i>in Lot 6 on RP41913</i>		 <b>Queensland Government</b> Natural Resources and Water
	PARISH: SURAT COUNTY: ELGIN	LOCALITY: PARKNOOK LOCAL AUTHORITY: ROMA REGIONAL	
Scale 1:7,500 at original size (A3)	REGION: SOUTH WEST Prepared By: DWB	Map Reference: 8743 Date: 03/03/2008	Compiled from: DCDB (MARCH 2008)
			<b>AP18773</b>

# Condamine and Balonne Tributaries Water Management Area

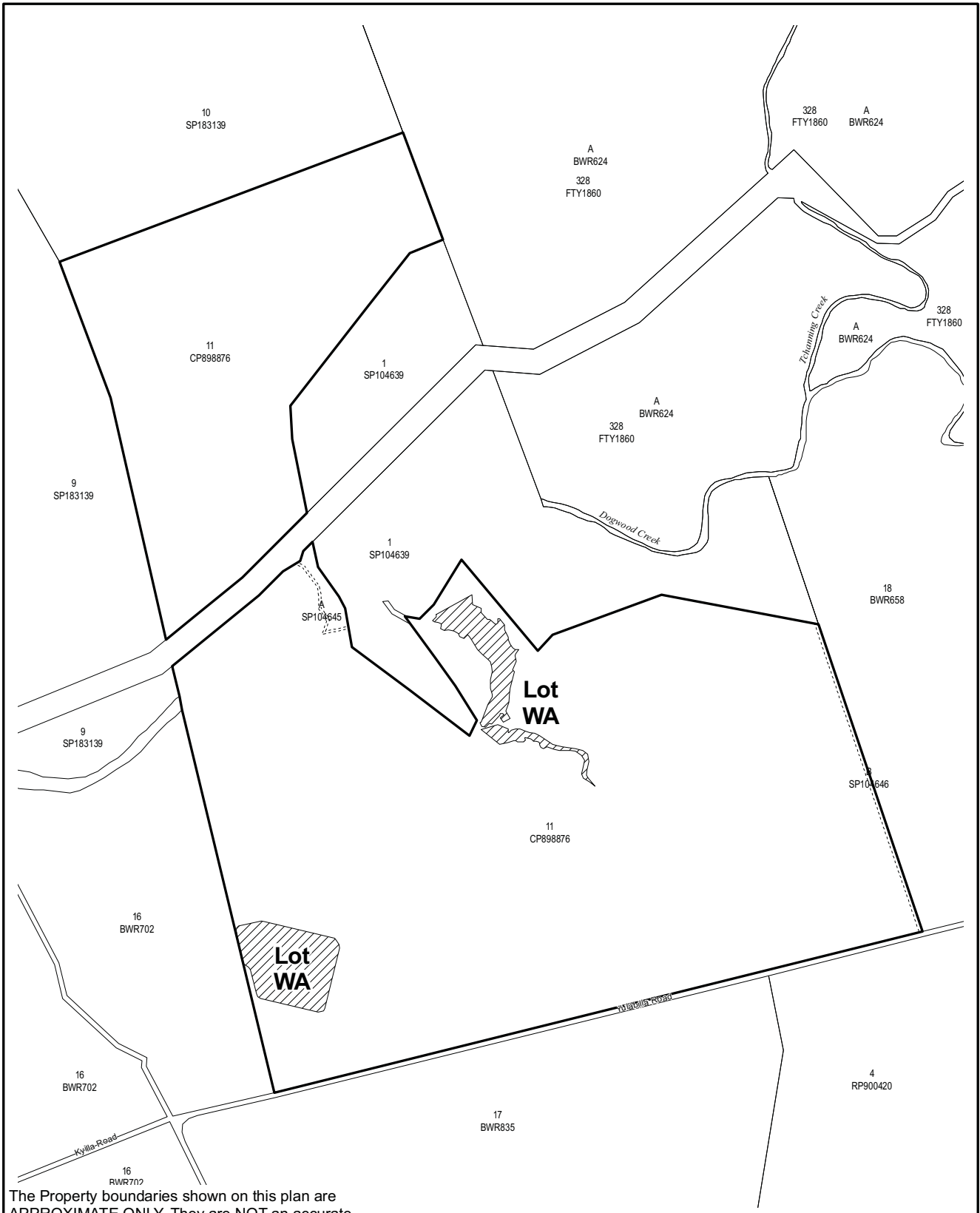

The Property boundaries shown on this plan are APPROXIMATE ONLY. They are NOT an accurate representation of the legal boundaries

<b>LEGEND</b> Waterharvesting Storage/s Parcels containing Storage/s	<b>Plan of Lot WA - abt 78 ha</b> <i>in Lot 11 on CP898876</i>		<b>Queensland Government</b> Natural Resources and Water
	PARISH: CALLITRIS COUNTY: BULWER	LOCALITY: YULABILLA LOCAL AUTHORITY: DALBY REGIONAL	
<b>Scale 1:30,000</b> at original size (A3)	<b>NORTH</b>	REGION: SOUTH WEST Prepared By: DWB      Date: 14/03/2008	Map Reference: 8843/8844 Compiled from: DCDB (MARCH 2008)
			<b>AP18801</b>

# Condamine and Balonne Tributaries Water Management Area

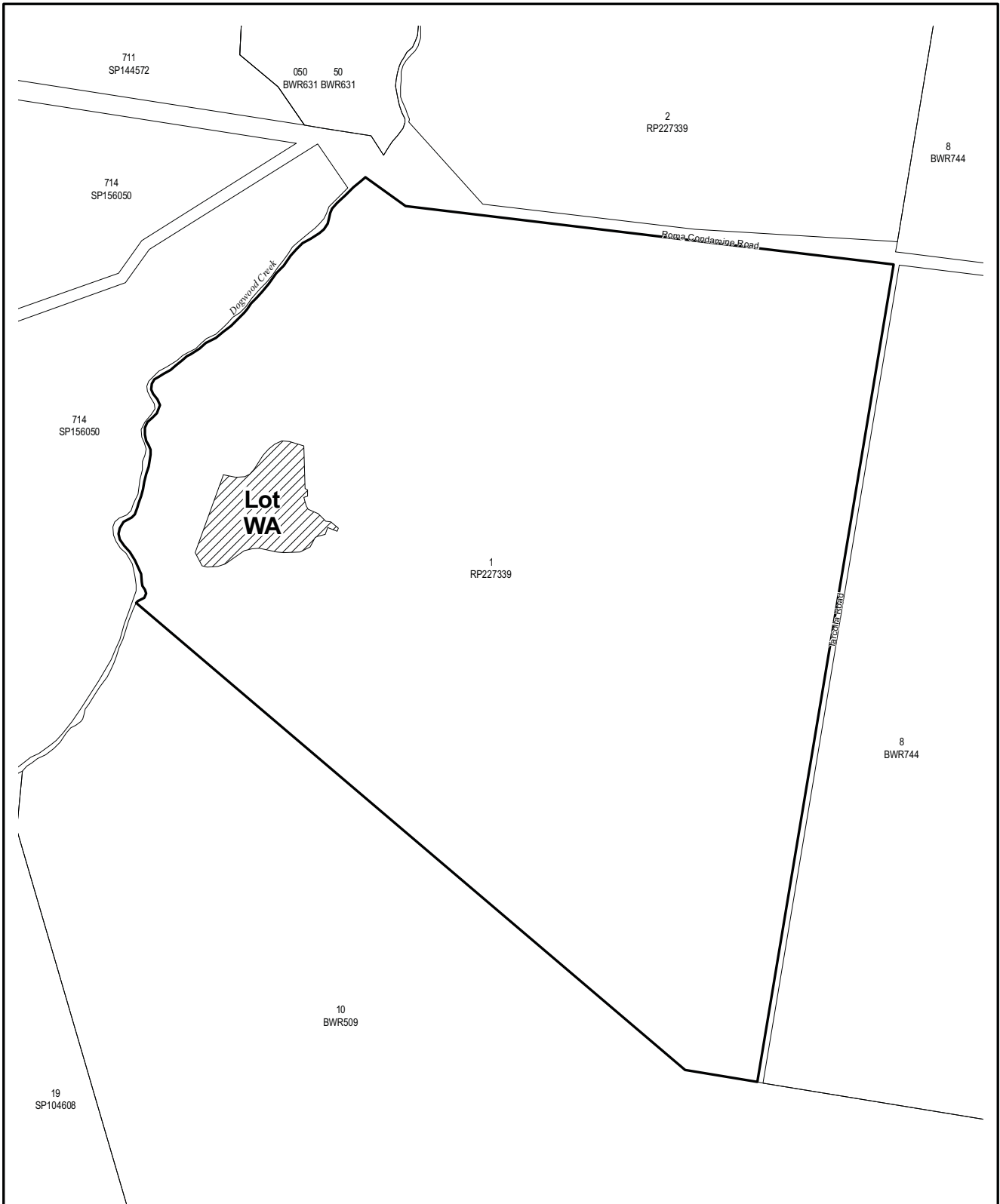

The Property boundaries shown on this plan are APPROXIMATE ONLY. They are NOT an accurate representation of the legal boundaries



<b>LEGEND</b> Waterharvesting Storage/s Parcels containing Storage/s	<b>Plan of Lot WA - abt 28 ha</b> <i>in Lot 1 on RP227339</i>		
	PARISH: MIAMBA COUNTY: BULWER	LOCALITY: MORABY LOCAL AUTHORITY: DALBY REGIONAL	
Scale <b>1:20,000</b> at original size (A3)	REGION: SOUTH WEST Prepared By: DWB	Map Reference: 8844 Date: 11/03/2008	
NORTH	Date: 11/03/2008	Compiled from: DCDB (MARCH 2008)	

# Condamine and Balonne Tributaries Water Management Area

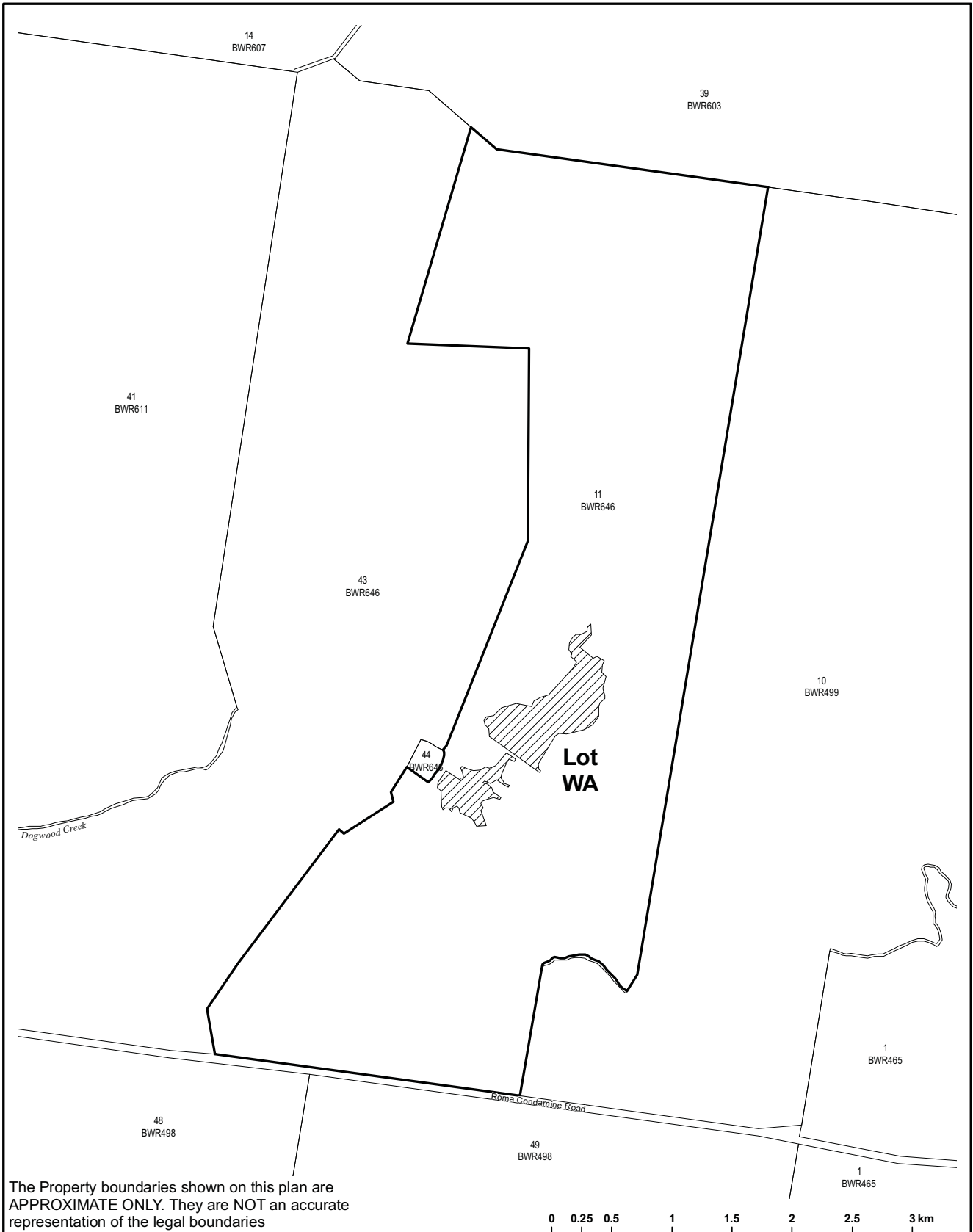

The Property boundaries shown on this plan are APPROXIMATE ONLY. They are NOT an accurate representation of the legal boundaries

<b>LEGEND</b> Waterharvesting Storage/s Parcels containing Storage/s	<b>Plan of Lot WA - abt 63 ha</b> <i>in Lot 11 on BWR646</i>		 <b>Queensland Government</b> Natural Resources and Water
	PARISH: WURAMA COUNTY: BULWER	LOCALITY: PINE HILLS LOCAL AUTHORITY: DALBY REGIONAL	
<b>Scale 1:30,000</b> at original size (A3)		REGION: SOUTH WEST Prepared By: DWB      Date: 11/03/2008	Map Reference: 8844 Compiled from: DCDB (MARCH 2008)
			<b>AP18786</b>