

Disclaimer: While every care is taken to ensure the accuracy of this product, the Department of Natural Resources and Mines makes no representations or warranties about its accuracy, reliability, completeness or suitability for any particular purpose and disclaims all responsibility and all liability (including without limitation, liability in negligence) for all expenses, losses, damages (including indirect or consequential damage) and costs which you might incur as a result of the product being inaccurate or incomplete in any way and for any reason.

© The State of Queensland (Department of Natural Resources and Mines) (2007)

Prepared by Water Industry Compliance
Dept. Natural Resources and Mines

APT 343

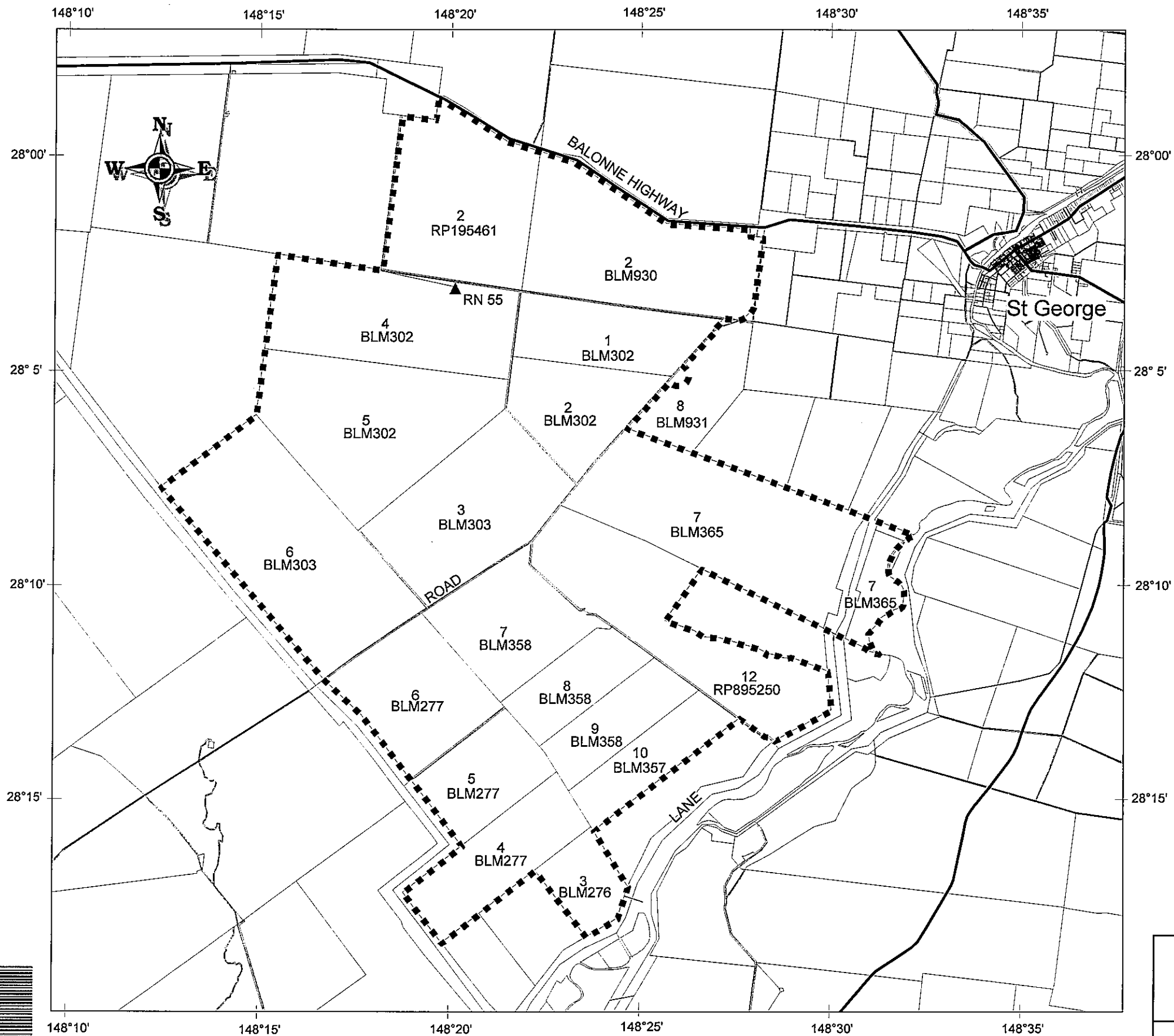

PLAN OF AREA

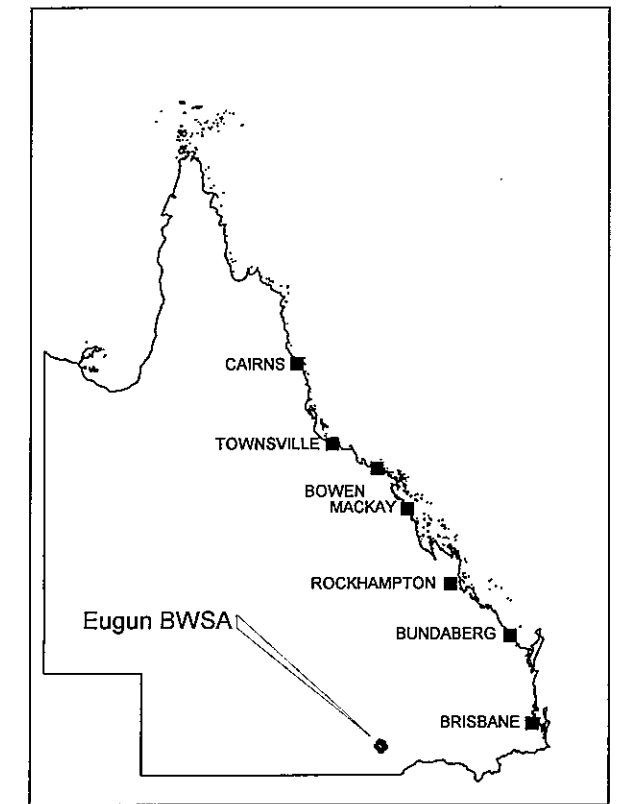
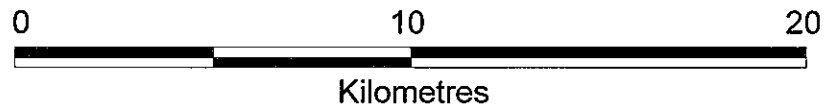

LOCATION MAP

LEGEND

- ▲ Registered Bore
RN 55
- ■ ■ ■ ■ Boundary of BWSA

Projection: GDA 94

Local Government **Balonne**
Date of Preparation **30 July 2001**

The cadastral information on this map is extracted from Digital Cadastre Data Base supplied by the Department of Natural Resources and Mines.

For information regarding the obligations of landholders and operation of water services within this Area, contact the Department of Natural Resources and Mines.



Queensland Government
Natural Resources and Mines

EUGUN

**BORE WATER AUTHORITY AREA
BOUNDARY PLAN**