

Disclaimer: While every care is taken to ensure the accuracy of this product, the Dept. of Natural Resources and Water makes no representations or warranties about its accuracy, reliability, completeness or suitability for any particular purpose and disclaims all responsibility and all liability (including without limitation, liability in negligence) for all expenses, losses, damages (including indirect or consequential damage) and costs which you might incur as a result of the product being inaccurate or incomplete in any way and for any reason.

Department of Natural Resources and Water (2008)

AP13404



Prepared by Water Industry Regulation
Dept. Natural Resources and Water

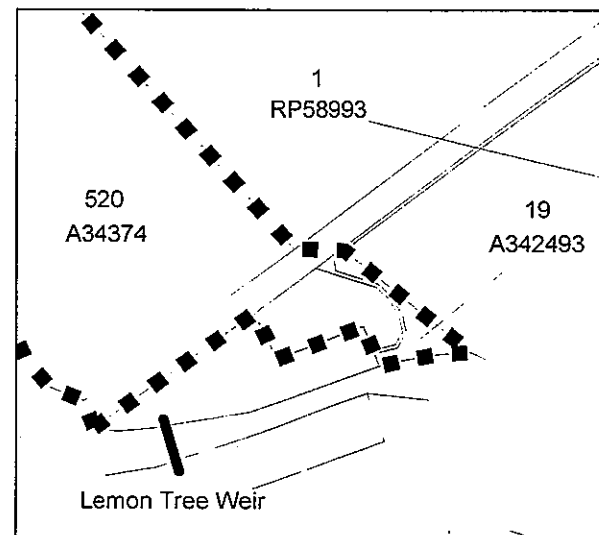
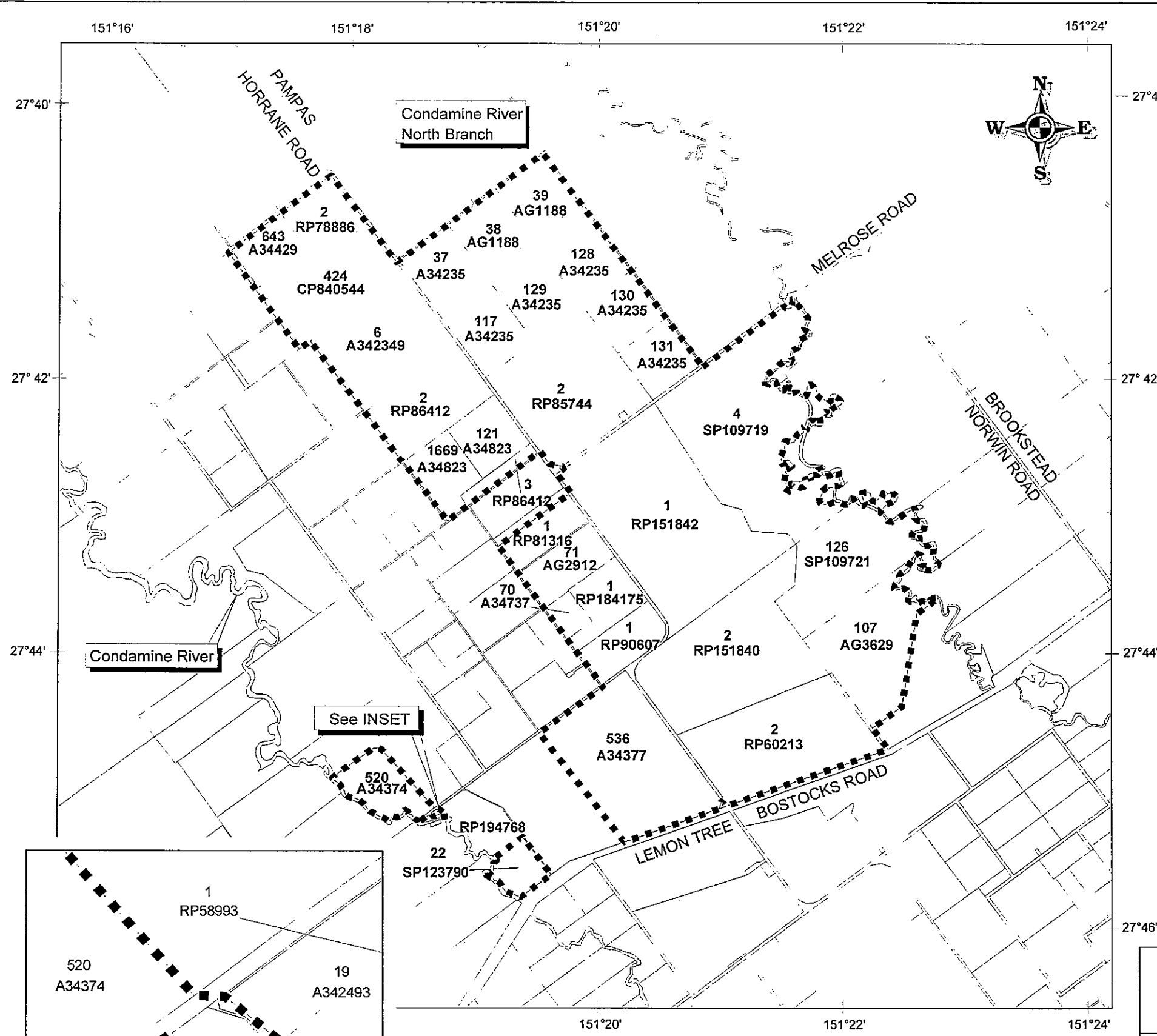

INSET

PLAN OF AREA

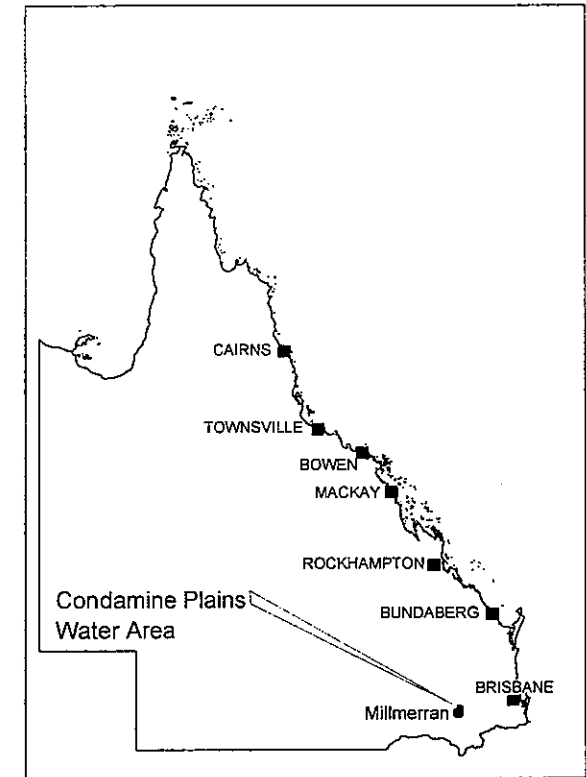
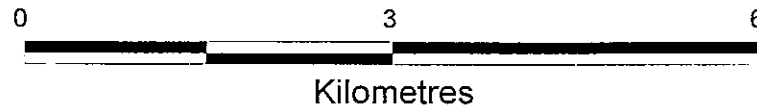

LOCATION MAP

LEGEND

Boundary of Water Area

Projection: GDA 94

Local Government: Millmerran
Date of Approval: 23 March 2007

The cadastral information on this map is extracted from Digital Cadastre Data Base supplied by the Department of Natural Resources and Water.

For information regarding the obligations of landholders and operation of water services within this Area, contact the Department of Natural Resources and Water.



Queensland Government
Natural Resources and Water

CONDAMINE PLAINS
WATER AREA
AREA PLAN