



**Queensland**  
**Government**  
**Natural Resources**  
**and Water**

**LAND INFORMATION AND TITLES**  
**LAND INFORMATION SERVICES**  
**CADASTRAL INFORMATION SERVICES**

**SPECIFICATION**

**QUEENSLAND INTERCHANGE FORMAT**  
**(QIF)**

Document Reference:	Q:\DCDBENHI\WORKING\TO QUALITY LIBRARY\QIFAPR_2008.DOC
Document Number	PDB/801/206
Version Number:	3.26
Version Date:	16 April 2008
Authors:	John Jensen

## COPYRIGHT

All rights reserved. No part of this document may be reproduced, stored in a retrieval system or transmitted in any form or by any means electronic, mechanical, photocopying, recording or otherwise, without prior written permission from the Land Information and Titles of the DEPARTMENT OF NATURAL RESOURCES AND WATER.

© Copyright The State of Queensland Department of Natural Resources and Water 2008.

## SUPERSESSION CLAUSE

Upon receipt of this document, please ensure that this page from any earlier version is returned to the issuer and the rest of the document is destroyed. No earlier version may be retained without the written permission of the Land Information and Titles document authorising officer.

## CONTROLLED COPY

**Date Issued:** \_\_\_/\_\_\_/\_\_\_ **Copy Number:** \_\_\_

**Issued To:** \_\_\_\_\_

**Issued By:** Project Quality Representative

## QUALITY ENDORSEMENT

The signing Quality Review Representatives certify that this document completely satisfy all agreed quality objectives.

Review Title: **Queensland Interchange Format**

Date of Endorsement: 13 May 2002

Endorsed By:

<b>Signature</b>	<b>Name</b>	<b>Title</b>	<b>Date</b>
Signed by L Lowry	Len Lowry	Manager, Geographic Data Services	13 May 2002
Signed by G Cislowski	Gary Cislowski	Quality Representative	13 May 2002



---

3.24	5/6/2006	C Stephanos	<ul style="list-style-type: none"><li>• 7.5 Change in Accuracy id – add ± to Accuracy Code column</li><li>• 7.5 Change in Accuracy id – add code ‘28’</li><li>• Add ‘Water’ to Departmental name</li></ul>
3.25	18/9/2006	C Stephanos	<ul style="list-style-type: none"><li>• Remove ‘Mines’ from Departmental name</li></ul>
3.26	16/4/2008	C Stephanos	<ul style="list-style-type: none"><li>• 7.4 Remove DCDB tenure codes AP and EP</li><li>• 7.7 Show new Local Government Names</li><li>• 7.8 Remove table showing conversion of 3 digit to 4 digit codes for Local Government Names</li></ul>

## **TABLE OF CONTENTS**

<b>1.0</b>	<b>PURPOSE</b> .....	<b>8</b>
<b>2.0</b>	<b>SCOPE</b> .....	<b>8</b>
<b>3.0</b>	<b>REFERENCES</b> .....	<b>8</b>
<b>4.0</b>	<b>DEFINITIONS</b> .....	<b>9</b>
<b>4.1</b>	<b>Area</b> .....	<b>9</b>
4.1.1	Area Field 1 - Surveyed Indicator .....	9
4.1.2	Area Field 2 - Area Value.....	9
<b>4.2</b>	<b>Before Image Record</b> .....	<b>9</b>
<b>4.3</b>	<b>BU - Building Unit Parcel</b> .....	<b>9</b>
<b>4.4</b>	<b>Co-ordinate values</b> .....	<b>10</b>
4.4.1	Australian Geodetic Datum (AGD84).....	10
4.4.2	Australian Map Grid (AMG 84).....	10
4.4.3	Geocentric Datum of Australia ( GDA94 ).....	11
4.4.4	Map Grid of Australia ( MGA94 ).....	11
<b>4.5</b>	<b>Coverage Type ‘B’, ‘E’, ‘S’ &amp; ‘V’</b> .....	<b>11</b>
4.5.1	B - Base Parcel .....	11
4.5.2	E - Easement Parcel .....	11
4.5.3	S - Strata Parcel .....	11
4.5.4	V – Volumetric Parcel .....	12
<b>4.6</b>	<b>Data Subfile</b> .....	<b>12</b>
<b>4.7</b>	<b>Excluded Area</b> .....	<b>12</b>
<b>4.8</b>	<b>File</b> .....	<b>13</b>
<b>4.9</b>	<b>File Header</b> .....	<b>13</b>
<b>4.10</b>	<b>Linestyle</b> .....	<b>13</b>
<b>4.11</b>	<b>Linework</b> .....	<b>13</b>
<b>4.12</b>	<b>Local Government Code</b> .....	<b>14</b>
<b>4.13</b>	<b>Locality Code</b> .....	<b>14</b>
<b>4.14</b>	<b>Lot Number</b> .....	<b>14</b>
<b>4.15</b>	<b>Meta Data</b> .....	<b>14</b>
<b>4.16</b>	<b>Parcel Corner Block</b> .....	<b>15</b>
<b>4.17</b>	<b>Parcel Count</b> .....	<b>15</b>
<b>4.18</b>	<b>Parcel Indicator</b> .....	<b>15</b>
<b>4.19</b>	<b>Parcel Number</b> .....	<b>16</b>
<b>4.20</b>	<b>Parcel Type</b> .....	<b>16</b>
<b>4.21</b>	<b>Parish Code</b> .....	<b>16</b>
<b>4.22</b>	<b>Plan Number</b> .....	<b>16</b>
<b>4.23</b>	<b>Point Movement Record</b> .....	<b>16</b>
<b>4.24</b>	<b>Positional Accuracy</b> .....	<b>17</b>
4.24.1	Accuracy Code .....	17
4.24.2	Maximum Error .....	17
<b>4.25</b>	<b>Segment Number</b> .....	<b>17</b>
<b>4.26</b>	<b>Tenure Code</b> .....	<b>18</b>
<b>4.27</b>	<b>Update Type Code</b> .....	<b>18</b>
<b>5.0</b>	<b>RESPONSIBILITIES</b> .....	<b>19</b>
<b>6.0</b>	<b>SPECIFICATIONS</b> .....	<b>19</b>
<b>6.1</b>	<b>Format of File Header Block:</b> .....	<b>19</b>
<b>6.2</b>	<b>Format of Subfile Header Record "SH":</b> .....	<b>20</b>

---

6.3	Format of Subfile Extent Record "SX": .....	20
6.4	Format of Before Image Parcel Record "OP": .....	21
6.5	Format of Before Image Parcel Corners Record "OC": .....	21
6.6	Format of Before Image Parcel Extension Record For Lot Type Parcel "OL": .....	22
6.7	Format of Before Image Record For BUP Type Parcel "OB": .....	22
6.8	Format of Before Image Record For BUP Lot Parcel "OU": .....	22
6.9	Format of Before Image Parcel Extension Record For Lot/Road/Watercourse Type Parcel 'OR': .....	23
6.10	Format of Parcel Record 'P': .....	23
6.11	Format of Parcel Corners Record 'PC': .....	23
6.12	Format of Parcel Extension Record For Lot Type Parcel 'EL': .....	24
6.13	Format of Parcel Extension Record For BUP Type Parcel 'EB': .....	24
6.14	Format of Parcel Extension Record For BUP Lot Parcel 'EU': .....	24
6.15	Format of Parcel Extension Record For Lot/Road/Watercourse Type Parcel 'ER': .....	25
6.16	Format of Point Movement Record 'XM': .....	25
6.17	Format of End of File Record '*EOF': .....	25
6.18	Format of Comment Record '*': .....	25
7.0	<b>DOCUMENTATION</b> .....	26
7.1	QIF File Structure .....	26
7.2	Sample of Initial QIF .....	27
7.3	Sample of Update QIF .....	30
7.4	DCDB Tenure Codes .....	34
7.5	DCDB Positional Accuracy Values .....	36
7.6	Example of Parcel Corner Block Record Starting Point .....	37
7.7	Queensland Local Government Areas .....	38
7.8	Conversion of Queensland Local Government Code (Three character – Four characters) .....	Error! Bookmark not defined.

## **1.0 PURPOSE**

This specification describes the format for interchange of digital cadastral data.

## **2.0 SCOPE**

QIF is the format for the interchange of digital cadastral data from Queensland's Digital Cadastral Database.

QIF is not intended to be a general graphics interchange format, however it is designed to be easily extended to include cadastral related data.

As such, care should be taken in writing programs to accept this format to allow for these future extensions. For example, it may be desirable in the future to include extra record types, so programs should be written to look for those records that they require, and ignore any others.

## **3.0 REFERENCES**

- PBD/801/200 Specifications for the Digitisation of Cadastre
- 1216.0 - Australian Standard Geographical Classification (ASGC). A classification system which divides Australia into geographical areas for the purpose of collecting and disseminating statistics (Local Government Codes)
- PVO/950/124 Procedure detailing the adoption and approval of Local Government Codes
- Australian Geodetic Datum Technical Manual Of The National Mapping Council (Special Publication No.10)
- Technical Manual for GDA94  
<http://www.anzlic.org.au/icsm/gdatm/chapter1.htm>
- Parish Map Directory, published by the Department of Natural Resources and Water
- PBD/801/201 Glossary of Terms

## 4.0 DEFINITIONS

### 4.1 Area

The area shown in the QIF file is the rateable area of a land parcel ie. the gross area minus any exclusions for public purposes such as a reserved road.

Area data is encoded in this specification in two fields.

#### 4.1.1 Area Field 1 - Surveyed Indicator

A 'surveyed indicator' field is a single character code used to indicate the status of the encoded area:

Code	Description
S	Surveyed area
U	Unsurveyed area

#### 4.1.2 Area Field 2 - Area Value

The 'area value' field for coverages 'B', 'S' and 'E' is a real number expressing the area of the parcel of land in square metres.

The 'area value' field for Volumetric coverage 'V' is a real number expressing the volume of a parcel of land in cubic metres. If the volume is  $> 100\,000\text{ m}^3$  then the volume will be displayed as an exponential notation with a mantissa taken to 5 significant figures eg  $3.1579 \times 10^6\text{ m}^3$ .

Note: Should the user wish to display the area in a specific unit format, the user should apply the appropriate conversion to the area value field.

### 4.2 Before Image Record

A Before Image record is a record of the DCDB as it existed before an update action.

The QIF record will be prefixed by an "O" (ie) "OP", "OC", "OL", "OB", "OU", "OR".

The Before Image record will only appear in an Update QIF file.

### 4.3 BUP - Building Unit Parcel

With the advent of the Department's new plan formats survey plans, the building format plan will encompass building unit and group title developments. These plans may be prefixed by a 'BUP', 'GTP', 'RP' or 'SP'.

A building format plan (for multi-level units) emerges from the vertical and/or horizontal subdivision of land into lots for individual ownership.

Multi-level building format plans will be shown in the database as a base parcel record. However if part of a multi-level building format plan is further subdivided, the subsequent building format plan will be shown as a strata parcel record.

In this case, the parcel co-ordinate records of the strata parcel building format plan will be the same as the base parcel building format plan. This is a constraint of the database.

#### **4.4 Co-ordinate values**

QIF data transfer will be available in any of the following co-ordinate systems:

- . Australian Geodetic Datum co-ordinates (AGD84);
- . Australian Map Grid co-ordinates (AMG84);
- . Geocentric Datum of Australia co-ordinates (GDA94);
- . Map Grid of Australia co-ordinates ( MGA94);

All co-ordinate values in a QIF data set will be right justified.

The Latitude co-ordinate values are implied as positive in a QIF file.

Consideration of this implied value will be necessary when displaying geographic co-ordinate values in any application.

##### **4.4.1 Australian Geodetic Datum (AGD84)**

The geographic co-ordinate reference system adopted for Australian National Spheroid references geographic co-ordinates that are based on the 1984 adopted adjustments of the Australian National Spheroid and is termed AGD84. (AGD84 is more specifically defined in National Mapping Council of Australia Special Publication No. 10)

##### **4.4.2 Australian Map Grid (AMG 84)**

The metric cartesian co-ordinate system is based on the Australian Geodetic Datum and the Universe Transverse Mercator Map Projection. The grid co-ordinates are based on the 1984 adopted adjustments to the Australian National Spheroid and is termed AMG84. (This term is more specifically defined in National Mapping Council of Australia Special Publication No. 10).

#### **4.4.3 Geocentric Datum of Australia ( GDA94 )**

The geographic co-ordinate reference system that replaces the Australian Geodetic Datum and is part of the global co-ordinate reference frame. The geographic co-ordinates are based on the Australian Fiducial Network (AFN) and the Australian National Network (ANN) in terms of the International Terrestrial Reference Frame 1992 mapped to a common epoch of 1994 and is termed GDA94. (GDA94 is more specifically defined in ICSM Geocentric Datum of Australia Technical Manual).  
<http://www.anzlic.org.au/icsm/gdatm/gdatm.htm>

#### **4.4.4 Map Grid of Australia ( MGA94 )**

The metric cartesian co-ordinate system that is based on the Geocentric Datum of Australia and the Universe Transverse Mercator Map Projection. The grid co-ordinates are based on the Australian Fiducial Network (AFN) and the Australian National Network (ANN) in terms of the International Terrestrial Reference Frame 1992 mapped to a common epoch of 1994 and is termed MGA94. (MGA94 is more specifically defined in ICSM Geocentric Datum of Australia Technical Manual).  
<http://www.anzlic.org.au/icsm/gdatm/gdatm.htm>

### **4.5 Coverage Type ‘B’, ‘E’, ‘S’ & ‘V’**

#### **4.5.1 B - Base Parcel**

The base parcel is that which makes up a complete coverage of the State - base parcels are contiguous with surrounding base parcels, "anything other is referred to as in strata, volumetric or an easement".

#### **4.5.2 E - Easement Parcel**

Easement parcels are non-base parcels. These parcels may overlap and may have an edge consistent with one or more edges of a base parcel.

#### **4.5.3 S - Strata Parcel**

Strata parcels are non-base parcels. These parcels may overlap and will not necessarily have linkages to base parcels.

An example of these parcels is a secondary lease over a base parcel, road parcel over a base parcel, road parcel over a base railway parcel, a permit over a base road parcel etc.

Note: - If a secondary lease over the base parcel has been issued using the same lot/plan description, the lot number of the secondary lease is amended by the addition of a prefix of zero. For example, where a base level parcel carries a lot description of Lot 2 on SL1234, the lot description of the secondary parcel shall become Lot 02 on SL1234. This will only occur

when the boundary of the secondary lease is totally co-incident with the base parcel.

#### **4.5.4 V – Volumetric Parcel**

Volumetric parcels are non-base parcels. These parcels may overlap and will not necessarily have linkages to base parcels.

The projected plan graphics of the volumetric parcel will be provided without reference to the height of the parcel.

The Department has amended the *Land Title Act 1994* to allow the creation of indefeasible title for airspace. The lots are defined by three-dimensional co-ordinates (ie volumetrically) and the issue of volumetric freehold title.

An example of these parcels is volumetric title over a base parcel (building), road parcel over a base parcel (bridge), railway parcel over a base road parcel (tunnel) etc.

#### **4.6 Data Subfile**

All cadastral data included has the following parcelling characteristics :

- Every parcel has one centroid that is located within the edges of that parcel;
- Adjoining base parcels are conterminous;
- Base parcels cannot overlap;
- Non-Base parcels may be coincident and or overlap.

For 'initial supply' of data, the largest subfile entity is a segment. A segment contains less than 1000 parcels, with not more than 2,000 plot co-ordinate pairs per parcel.

For 'update' purposes a data subfile may contain parts of a number of segments. In this case the limits are not more than 3,000 parcels with not more than 2,000 points in any one parcel.

For other purposes please contact the Department of Natural Resources and Water for advice on data subfile capabilities.

#### **4.7 Excluded Area**

An area of land within a title area may be set apart for future road or other public purposes as defined within the Land Act 1994. The area is excluded by title and the total area of such exclusions is recorded using the same coding convention as for the 'Area'.

## 4.8 File

A file consists of file header, several data subfiles and meta data information.

A file is terminated by an end of file (EOF) marker. (Refer to 7.1 File Structure.)

## 4.9 File Header

A file header is the first subfile of the file. It consists of a 10 record block (left justified) and describes the contents of the data subfile. This narrative varies depending on whether the dataset is for the supply of initial DCDB data or for the supply of update DCDB data.

The last (10th) record only is formatted. (Refer to 6.1.)

The header records are left justified with the leading two character blanks.

## 4.10 Linestyle

The linestyle code is a single character record assigned to the differing line elements in the DCDB.

The record is left justified in a four character field.

The linestyle convention used for the supply of data are:

<b>Code</b>	<b>Description</b>
0	Surveyed right line boundary
1	Unsurveyed right line boundary
2	Surveyed natural boundary
3	Unsurveyed natural boundary
4	Digital construction line
5	Road parcel boundary line (between two road parcels)
6	Surveyed right line road boundary
7	Unsurveyed right line road boundary
8	Surveyed natural road boundary
9	Unsurveyed natural road boundary

## 4.11 Linework

Linework data for each subfile included in the QIF file is determined from all the parcel corner blocks of the subfile.

The minimum length of line in the DCDB will be 1cm.

#### **4.12 Local Government Code**

A numeric code that uniquely identifies the Local Government area in Queensland.

Provision has been made to accept a four character numeric code, right justified, that will uniquely identify the Local Government areas in Australia.

The Local Government four character numeric code produced by the Australian Bureau of Statistics and is described in 1216.0 – Australian Standard Geographical Classification (ASGC) is the coding standard for Local Government identification for the Department of Natural Resources and Water.

#### **4.13 Locality Code**

Locality code is the numeric code, system generated, assigned to the localities in the DCDB.

This code number uniquely identifies each locality within its respective Local Government area.

An ASCII delimited file of locality number, locality name, Local Government number and Local Government name can be provided on request.

#### **4.14 Lot Number**

The lot number is a five character record that describes a parcel of land in conjunction with the plan number. The lot number can be either alpha or numeric and is right justified.

#### **4.15 Meta Data**

Meta data will be provided in all QIF file as a ‘Comment Record’. ( Refer to 6.18.) This comment record will appear at the end of the data subfiles.

This record will describe metadata for the DCDB and statistics of the extracted dataset.

#### 4.16 Parcel Corner Block

A parcel corner block consists of a block of parcel corner records 'PC' (Refer to 6.11). This block describes a parcel polygon stored in a clockwise direction with an implied connection between the last co-ordinate pair and the first. The linestyle preceding the first co-ordinate pair refers to this implied connection.

A parcel corner block record will begin with a road boundary and the starting point will be the most westerly value of a join between a non-road and a road boundary and if necessary the point with the minimum northerly value.

For other parcels the starting point of a parcel corner block will be the most westerly value and the minimum northerly value.

For linework to be established for the subfile all the parcel corner blocks must be used.

#### 4.17 Parcel Count

Parcel count is a count of the number of parcels that form a Lot in the DCDB.

The record is right justified in a three character field.

This record will allow users to ascertain if all parcels for a Lot are present in the extracted window.

#### 4.18 Parcel Indicator

The parcel indicator is a two character numeric code assigned to parcels to indicate its status.

The parcel indicator codes used in the DCDB are:

Code	Description
00	Lots
79	Reserved Esplanade
80	Watercourse
81	Road
82	Intersection
83	Closed road (Temporary)
85	Esplanade
88	Canal
89	Channel
90	Drain
91	Sea
92	Adjoining State

#### **4.19 Parcel Number**

A three character identifier allocated to each polygon at the time of capture. DCDB parcels are uniquely numbered within a segment and this segment/parcel combination is used as a primary link between the graphics data and the attribute data in the DCDB.

This segment/parcel number combination is an internal identifier for the DCDB and as such may be subject to change during the DCDB updating process.

#### **4.20 Parcel Type**

The parcel type is a one character alpha code assigned to a parcel to indicate its status.

Its main use in the database is to determine the output display of the DCDB.

<b>Code</b>	<b>Description</b>
E	Easement parcel
I	Intersection parcel
L	Lot parcel
R	Road parcel
W	Water parcel
T	Other

#### **4.21 Parish Code**

Parish code is the unique numeric parish number (1-5317) as defined in the Parish Directory of the Department of Natural Resources and Water. The parish number is a unique identifier for both parish and county.

The Parish Directory is no longer published however an ASCII delimited file of parish number, parish name and county name can be provided on request.

#### **4.22 Plan Number**

The plan number is a ten character record that describes a parcel of land in conjunction with the lot number. The plan number must begin with an alpha character to a maximum of five with the balance being numeric. The record is left justified.

#### **4.23 Point Movement Record**

A point movement record provides two values for a parcel corner. The values on the left are the previous easting and northing of a parcel corner while the values on the right are its new easting and northing. (This record is only present in update QIF files.)

The point movement record will be provided only for a new parcel corner or for a deleted parcel corner or for parcel corners that have changed position. Null values will not be provided.

#### 4.24 Positional Accuracy

Positional accuracy values are attached to the parcel record. The positional accuracy of a parcel will consist of an Accuracy Code and a Maximum Error which is expressed as a  $\pm$  value.

##### 4.24.1 Accuracy Code

Accuracy code is an indicator of the source of the captured DCDB data. The record is an alpha code, right justified.

Code	Description
S	Derived from Standard cadastral mapping at various scales
P	Derived from Provisional cadastral mapping at various scales
O	Derived from Orthophoto standard mapping at various scales
I	Derived from Parish maps, standard 1:100000 control
B	Bearing and Distance Plots, geodetic control
R	Position upgrade, Rectification, geodetic control
T	Position upgrade, Photogrammetry, geodetic control
A	Position upgrade, Satellite imagery
C	Position upgrade, Imagery, Geodetic Control, Graphical Adjustment
X	No value

##### 4.24.2 Maximum Error

It has been established that the statement shall include a finite value representing the "maximum error" based on the source map type and scale of capture or an upgrade transformation.

The values are either the "root mean square" results of precision of digitising and map accuracy, expressed in metres or an upgrade accuracy statement assigned to the parcel, at the 95% confidence level.

The record is numeric, right justified in a six character field.

An ASCII delimited file of accuracy\_id, accuracy description, accuracy code and error value in mm can be provided on request.

Sample values are shown in 7.5 DCDB Positional Accuracy Values.

#### 4.25 Segment Number

A five character unique identifier allocated to a group of parcels at the time of capture. Its use is to facilitate the handling and retrieval of data in the DCDB.

This segment/parcel number combination is an internal identifier for the DCDB and as such may be subject to change during the DCDB updating process.

## 4.26 Tenure Code

The tenure code is a two character alpha code assigned to lot on plan descriptions to indicate the right or title by which land is held.

A brief explanation of the tenure codes is shown in 7.4 DCDB Tenure Codes.

## 4.27 Update Type Code

Each Update to the DCDB is tracked by means of an Update number, Update type and an Update date. These are system derived and will only appear in an incremental update QIF file.

Update Codes:

Code	Description
0	No attribute or graphics change
1	Attribute only change
2	Graphics only change
3	Upgraded position change
4	Attribute and graphics change

Explanation of Individual Codes:

Type 0 - No attribute or graphic change

This code is attached to data being necessarily supplied in conjunction with other update data even though there has been no change to this actual parcel.

Type 1 - Attribute change only

This update type indicates there has been no change to the graphics of a parcel (same graphics, same segment parcel numbering), but attribute data has changed.

Type 2 - Graphics change only

This update type indicates addition or deletion of points of a polygon with no resultant change to the attributes of the polygon. This change would not require a new plan of survey.

Type 3 - Upgraded position for parcel

This update type indicates there would be no change to the number of points in the parcel, but the positional and relative properties of the parcel have changed. This would result from a software transformation of the polygon. No attribute changes.

### Type 4 - New graphics and attributes

This update type indicates that a parcel has been subdivided and would require a new plan of survey.

## 5.0 RESPONSIBILITIES

- The Manager, Cadastral Information Services, is responsible for the management of Queensland Interchange Format (QIF).
- The Principal Cartographer (TO5), Cadastral Information Services, is responsible for the implementation of the Specification - Queensland Interchange Format (QIF).

## 6.0 SPECIFICATIONS

### 6.1 Format of File Header Block:

This header subfile indicates the data type being supplied to a client. Records 1 - 9 shall contain a narrative describing the dataset and the copyright conditions that apply to the data.

Record 10 of the header subfile is the only formatted record and it will contain:

Character	Name	Contents
1 - 3		blank
4 - 8	Co-ordinate type	"AMG84 or AGD84" for the AGD84 datum or "MGA94 or GDA94" for the GDA94 datum.
9		blank
10 - 11	Zone	of the grid co-ordinates 54,55 or 56 ( blank if geographic co-ordinates)
12 - 18		blank
19 - 33	Min easting	(over whole file,
34 - 48	Min northing	i.e. of south west corner)
49 - 63	Max easting	(over whole file,
64 - 78	Max northing	i.e. of north east corner)

## 6.2 Format of Subfile Header Record "SH":

Character	Name	Contents
1 - 2	Record type	"SH"
3 - 10		blank
11 - 15	Segment number	numeric right justified, NRM internal use only. (Note: 2)
16 - 18		blank
19 - 33	Easting	of subfile ref. point
34 - 48	Northing	of subfile ref. point
49 - 52	Year	( format 'ccyy' )
53 - 54	Month	01 to 12
55 - 56	Day	01 to 31
57 - 58	Hour	00 to 23
59 - 60	Minute	00 to 59
61 - 70	Update sequence number	1 to 1000000000 (A unique number allocated to each update in chronological order. Only present in Update QIF files)

Note: 1 - Values in characters 49 - 70 are only present in an Update QIF file.

Note: 2 - Values in characters 11 - 15 are not available in an Update QIF file.

Note: 3 - The subfile reference point will be a point within the subfile outer boundary, and in the case of a subfile containing a whole segment, will be the segment reference point.

Note: 4 - In an update QIF file, the data subfiles are displayed in update number sequence. This update number is generated and time stamped when the original parcel data is locked for an update operation. When parcel data is locked, no other updates can be effected over the locked region until the locked data is returned to the database. The date value assigned to the update number is the date the updated parcel data was returned and signed off in the DCDB.

Note: 5 - The data subfiles of a QIF update file should be applied to a client dataset in update number sequence.

## 6.3 Format of Subfile Extent Record "SX":

Character	Name	Contents
1 - 2	Record type	"SX"
3 - 18		reserved
19 - 33	Min easting	(over this subfile,
34 - 48	Min northing	i.e. of south west corner)
49 - 63	Max easting	(over this subfile,
64 - 78	Max northing	i.e. of north east corner)

Note: - This record gives the smallest window covering the subfile which is rectangular in the co-ordinate system in use.

#### 6.4 Format of Before Image Parcel Record "OP":

Character	Name	Contents
1 - 2	Record type	"OP "
3 - 10		blank
11 - 15	Segment number	numeric, right justified, NRM internal use only
16 - 18	Parcel number	numeric, right justified, NRM internal use only
19 - 33	Centroid easting	numeric
34 - 48	Centroid northing	numeric
49 - 52	Local Government	numeric, right justified
53 - 54	Parcel indicator	numeric
55 - 56		blank
57 - 57	Parcel type	alpha
58 - 58	Coverage	refer to Coverage Type – 'B', 'E', 'S' or 'V'
59 - 62	Locality code	numeric, right justified
63 - 64	Accuracy code	alpha, right justified
65 - 70	Maximum error	numeric/special character, right justified

#### 6.5 Format of Before Image Parcel Corners Record "OC":

Character	Name	Contents
1 - 2	Record type	"OC"
3 - 3	Pen indicator	"+" only.
4 - 7	Linestyle	numeric, left justified
8		blank
9 - 23	Easting	right justified
24 - 38	Northing	right justified
39 - 42		blank
43 - 43	Pen indicator	"+" only.
44 - 47	Linestyle	numeric, left justified
48		blank
49 - 63	Easting	right justified
64 - 78	Northing	right justified

## 6.6 Format of Before Image Parcel Extension Record For Lot Type Parcel "OL":

Character	Name	Contents
1 - 2	Record type	"OL"
3 - 12	Plan number	alphanumeric, left justified
13 - 14		blank
15 - 19	Lot number	alpha or numeric, right justified
20 - 23	Parish code	numeric, right justified
24 - 24	Surveyed Indicator	alpha, refer to Area definition
25		blank
26 - 41	Area	Square metres for 'B', 'E' & 'S' coverage or Cubic metres for 'V' coverage
42		blank
43 - 58	Excluded area	Square metres
59 - 60	Tenure code	alpha
61		blank
62 - 64	Parcel count	numeric, right justified

## 6.7 Format of Before Image Record For BUP Type Parcel "OB":

Character	Name	Contents
1 - 2	Record type	"OB"
3 - 12	Plan number	alphanumeric, left justified
13 - 19		blank
20 - 23	Parish code	numeric, right justified
24 - 24	Surveyed Indicator	alpha
25 - 58		blank
59 - 60	Tenure code	alpha
61		blank
62 - 64	Parcel count	numeric, right justified

## 6.8 Format of Before Image Record For BUP Lot Parcel 'OU':

Character	Name	Contents
1 - 2	Record type	"OU"
3 - 12	Plan number	alphanumeric, left justified
13 - 14		blank
15 - 19	Lot number	numeric, right justified
20 - 23	Parish code	numeric, right justified
24 - 24	Surveyed Indicator	alpha
25		blank
26 - 41	Area	Square metres
42 - 58		blank
59 - 60	Tenure code	alpha

## 6.9 Format of Before Image Parcel Extension Record For Lot/Road/Watercourse Type Parcel 'OR':

Character	Name	Contents
1 - 2	Record type	"OR"
3 - 32	Lot/Road/ Watercourse name	alpha/numeric/ special character, left justified
33 - 62	Locality	Suburb or Town, left justified

## 6.10 Format of Parcel Record 'P':

Character	Name	Contents
1 - 2	Record type	"P "
3 - 10		Blank
11 - 15	Segment number	numeric, right justified, NRM internal use only
16 - 18	Parcel number	numeric, right justified, NRM internal use only
19 - 33	Centroid easting	numeric
34 - 48	Centroid northing	numeric
49 - 52	Local Government	numeric, right justified
53 - 54	Parcel indicator	numeric
55 - 56	Update type	numeric, right justified, refer to Update Type codes
57 - 57	Parcel type	alpha
58 - 58	Coverage	refer to Coverage Type – 'B', 'E', 'S' or 'V'
59 - 62	Locality code	numeric, right justified
63 - 64	Accuracy code	alpha, right justified
65 - 70	Maximum error	numeric/special character, right justified

## 6.11 Format of Parcel Corners Record 'PC':

Character	Name	Contents
1 - 2	Record type	"PC"
3 - 3	Pen indicator	"+" only.
4 - 7	Linestyle	numeric, left justified
8		blank
9 - 23	Easting	right justified
24 - 38	Northing	right justified
39 - 42		blank
43 - 43	Pen indicator	"+" only.
44 - 47	Linestyle	numeric, left justified
48		blank
49 - 63	Easting	right justified
64 - 78	Northing	right justified

## 6.12 Format of Parcel Extension Record For Lot Type Parcel 'EL':

Character	Name	Contents
1 - 2	Record type	"EL"
3 - 12	Plan number	alphanumeric, left justified
13 - 14		blank
15 - 19	Lot number	alpha or numeric, right justified
20 - 23	Parish code	numeric, right justified
24 - 24	Surveyed Indicator	alpha
25		blank
26 - 41	Area	Square metres for 'B', 'E' & 'S' coverage or Cubic metres for 'V' coverage
42		blank
43 - 58	Excluded area	Square metres
59 - 60	Tenure code	alpha
61		blank
62 - 64	Parcel count	numeric, right justified

## 6.13 Format of Parcel Extension Record For BUP Type Parcel 'EB':

Character	Name	Contents
1 - 2	Record type	"EB"
3 - 12	Plan number	alphanumeric, left justified
13 - 19		blank
20 - 23	Parish code	numeric, right justified
24 - 24	Surveyed indicator	alpha
25 - 58		blank
59 - 60	Tenure code	alpha
61		blank
62 - 64	Parcel count	numeric, right justified

## 6.14 Format of Parcel Extension Record For BUP Lot Parcel 'EU':

Character	Name	Contents
1 - 2	Record type	"EU"
3 - 12	Plan number	alphanumeric, left justified
13 - 14		blank
15 - 19	Lot number	numeric, right justified
20 - 23	Parish code	numeric, right justified
24 - 24	Surveyed Indicator	alpha
25		blank
26 - 41	Area	Square metres
42 - 58		blank
59 - 60	Tenure code	alpha

### 6.15 Format of Parcel Extension Record For Lot/Road/Watercourse Type Parcel 'ER':

Character	Name	Contents
1 - 2	Record type	"ER"
3 - 32	Lot/Road/ Watercourse name	alpha/numeric/ special character, left justified
33 - 62	Locality	Suburb or Town, left justified

Note: - If two or more 'ER' records are displayed for any parcel record, then the first 'ER' record will be the Primary name of the feature and the second name will be an alias.

This will not be valid for an Intersection 'I' type parcel.

### 6.16 Format of Point Movement Record 'XM':

Character	Name	Contents
1 - 2	Record Type	"XM"
3 - 3	Point indicator	"-" for new point "+" for deleted or changed point
4 - 8		blank
9 - 23	Old Easting	numeric
24 - 38	Old Northing	numeric
39 - 42		blank
43 - 43	Point indicator	"-" for deleted point "+" for new or changed point
44 - 48		blank
49 - 63	New Easting	numeric
64 - 78	New Northing	numeric

### 6.17 Format of End of File Record '\*EOF':

Character	Name	Contents
1 - 4	Record type	"*EOF"
5 - 12	Record count	a count of all records in the file (including the header subfile and this record)

### 6.18 Format of Comment Record '\*':

This record may appear in any data subfile between logical blocks of data and should be ignored as the file is read. Some programs may list comment records encountered on input.

Character	Name	Contents
1 - 2	Record type	"* "
3 - 78	Comments	any printable characters

Note: - Comment records may appear in any data subfile between logical blocks of data.

## 7.0 DOCUMENTATION

### 7.1 QIF File Structure

1 File Header Subfile being: A Block of 10 records describing the file dataset (left justified)	(see 6.1)
1 or more Data Subfiles containing:	
A "SH" record containing: internal Department of Natural Resources and Water identification, easting and northing or longitude and latitude of subfile reference point	(see 6.2)
A "SX" record containing: co-ordinates of the southwest and northeast corners of a rectangular window containing the subfile.	(see 6.3)
A Before Image parcel block (updates only)	
For each parcel Before Image a "OP" record	(see 6.4)
For parcel corners a "OC" record	(see 6.5)
For Lot/Plan identified parcels a "OL" record.	(see 6.6)
For Building Unit Plan base parcels a "OB" record followed by one or more "OU" records.	(see 6.7) (see 6.8)
For named parcels, one or more "OR" records.	(see 6.9)
(Subsequent Before Image records)	
An After Image parcel block or Initial Supply	
For each parcel After Image a "P" record	(see 6.10)
a "PC" record containing co-ordinates of each parcel corner	(see 6.11)
For Lot/Plan identified parcels a "EL" record.	(see 6.12)
For Building Unit Plan base parcels a "EB" record followed by one or more "EU" records	(see 6.13) (see 6.14)
For named parcels, one or more "ER" records.	(see 6.15)
(Subsequent After Image records)	
A point movement block (in update QIF files) consisting of a "XM" point movement record containing previous co-ordinates for points and new co-ordinates for points	(see 6.16)
(Subsequent data subfiles)	
End of file record -	(see 6.17)

## 7.2 Sample of Initial QIF

THIS DATA SET IS AN EXTRACT FROM QUEENSLAND'S DIGITAL CADASTRAL DATABASE.  
USE OF THIS DATA SET MAY BE APPROVED WITH THE WRITTEN PERMISSION OF THE  
DIRECTOR GENERAL, DEPARTMENT OF NATURAL RESOURCES AND WATER,  
LOCKED BAG 40, COORPAROO DELIVERY CENTRE, 4151, QUEENSLAND, AUSTRALIA.  
COPYRIGHT, QUEENSLAND, DEPARTMENT OF NATURAL RESOURCES AND WATER, 2004.  
NO LIABILITY ACCEPTED FOR ANY LOSS OR DAMAGE THAT MAY ARISE FROM THE USE OF OR  
RELIANCE ON THIS DATA. DATA CONFORMS TO SPECIFICATION PBD/801/206 VER.3.21.

INITIAL DATA - SURVCAL  
DATA IN MGA94 ON GDA94  
EXTRACTED 24/02/2004 12:53

MGA94 56	496100.245	6967079.732	496331.513	6967187.579
SH 27082	496209.014	6967133.374		
SX	496100.245	6967079.732	496331.513	7134645.971
P 27082 1	496112.477	6967123.446100000	LB1747 S	1.5
PC+0	496119.264	6967106.048	+6	496100.245
PC+0	496105.811	6967140.845	+0	496124.709
ELRP160610	1091771S	597.00	FH 1	
P 27082 2	496117.983	6967154.969100000	LB1747 S	1.5
PC+0	496111.377	6967172.358	+6	496130.155
PC+0	496124.709	6967137.581	+0	496105.811
ELRP160610	891771S	598.00	FH 1	
P 27082 3	496131.102	6967120.239100000	LB1747 S	1.5
PC+0	496137.494	6967102.899	+6	496119.264
PC+0	496124.709	6967137.581	+0	496142.940
ELRP160610	1081771S	591.00	FH 1	
P 27082 5	496125.916	6967177.452100081	RB1747 S	1.5
PC+5	496137.311	6967167.878	+6	496130.155
PC+6	496111.377	6967172.358	+6	496113.986
PC+6	496139.864	6967182.659		
ERKARRABIN STREET		MITCHELTON		
P 27082 6	496149.240	6967117.106100000	LB1747 S	1.5
PC+0	496155.540	6967099.782	+6	496137.494
PC+0	496142.940	6967134.432	+0	496160.985
ELRP160610	1071771S	585.00	FH 1	
P 27082 7	496167.285	6967113.989100000	LB1747 S	1.5
PC+0	496173.585	6967096.665	+6	496155.540
PC+0	496160.985	6967131.314	+0	496179.030
ELRP160610	1061771S	585.00	FH 1	
P 27082 8	496185.422	6967110.856100000	LB1747 S	1.5
PC+0	496191.815	6967093.516	+6	496173.585
PC+0	496179.030	6967128.197	+0	496197.260
ELRP160610	1051771S	591.00	FH 1	
P 27082 9	496203.760	6967107.688100000	LB1747 S	1.5
PC+0	496210.261	6967090.329	+6	496191.815
PC+0	496197.260	6967125.048	+0	496215.706
ELRP160610	1041771S	597.00	FH 1	
P 27082 10	496222.360	6967104.476100000	LB1747 S	1.5
PC+0	496229.014	6967087.090	+6	496210.261
PC+0	496215.706	6967121.862	+0	496234.459
ELRP160610	1031771S	607.00	FH 1	
P 27082 11	496241.113	6967101.236100000	LB1747 S	1.5
PC+0	496247.768	6967083.850	+6	496229.014
PC+0	496234.459	6967118.622	+0	496253.213
ELRP160610	1021771S	607.00	FH 1	
P 27082 12	496259.636	6967098.037100000	LB1747 S	1.5
PC+0	496266.059	6967080.690	+6	496247.768
PC+0	496253.213	6967115.383	+0	496271.504
ELRP160610	1011771S	591.00	FH 1	
P 27082 13	496281.046	6967095.977100000	LB1747 S	1.5
PC+0	496296.033	6967092.865	+6	496288.211
PC+6	496283.194	6967081.574	+6	496277.312
PC+6	496271.149	6967079.811	+6	496266.059
PC+0	496271.504	6967112.223	+0	496286.449
ELRP160610	1001771S	620.00	FH 1	
P 27082 14	496300.677	6967116.346100000	LB1747 S	1.5
PC+0	496298.006	6967139.827	+6	496299.552
PC+6	496302.748	6967137.293	+6	496305.294
PC+6	496312.909	6967123.390	+6	496314.906
PC+6	496314.379	6967112.734	+6	496311.442
PC+6	496296.033	6967092.865	+0	496286.449
ELRP160610	991771S	769.00	FH 1	
P 27082 15	496284.755	6967126.699100000	LB1747 S	1.5
PC+0	496276.949	6967143.757	+6	496293.005
PC+6	496295.930	6967140.478	+6	496298.006
PC+0	496286.449	6967109.642	+0	496271.504
ELRP160610	981771S	585.00	FH 1	
P 27082 16	496318.403	6967136.026100081	RB1747 S	1.5
PC+5	496312.909	6967123.390	+6	496305.294
PC+5	496319.955	6967148.662	+6	496331.513
ERKARRABIN STREET		MITCHELTON		
P 27082 17	496306.480	6967147.580100082	IB1747 S	1.5
PC+5	496295.559	6967155.764	+6	496298.670
PC+6	496301.222	6967157.848	+6	496302.533
PC+5	496317.565	6967159.584	+6	496317.404

Department of Natural Resources and Water Land Information and Titles  
Specification – Queensland Interchange Format ( QIF )

PBD/801/206

Issue: 3.26

Page 28 of 38

PC+6	496318.219	6967152.054	+6	496319.955	6967148.662
PC+5	496305.294	6967134.476	+6	496302.748	6967137.293
PC+6	496299.552	6967139.342	+6	496298.006	6967139.827
PC+6	496295.930	6967140.478	+6	496293.005	6967140.983
ERKARRABIN STREET MITCHELTON					
ERLOCKROSE STREET MITCHELTON					
P	27082 18	496151.925		6967175.424100082	IB1747 S 1.5
PC+5	496139.864	6967182.659	+6	496142.976	6967182.942
PC+6	496145.528	6967184.743	+6	496146.839	6967187.579
PC+5	496161.620	6967185.025	+6	496161.903	6967181.914
PC+6	496163.704	6967179.361	+6	496166.539	6967178.051
PC+5	496163.986	6967163.270	+6	496148.385	6967165.965
PC+6	496137.311	6967167.878			
ERKARRABIN STREET MITCHELTON					
ERKENTVILLE STREET MITCHELTON					
P	27082 19	496268.696		6967152.794100081	RB1747 S 1.5
PC+5	496244.386	6967164.604	+6	496269.973	6967160.184
PC+6	496295.559	6967155.764	+5	496293.005	6967140.983
PC+6	496276.949	6967143.757	+6	496258.658	6967146.917
PC+6	496241.833	6967149.823			
ERKARRABIN STREET MITCHELTON					
P	27082 20	496229.772		6967161.977100082	IB1747 S 1.5
PC+5	496217.712	6967169.212	+6	496220.823	6967169.495
PC+6	496223.375	6967171.296	+6	496224.686	6967174.131
PC+5	496239.467	6967171.578	+6	496239.750	6967168.467
PC+6	496241.550	6967165.914	+6	496244.386	6967164.604
PC+5	496241.833	6967149.823	+6	496239.904	6967150.156
PC+6	496221.151	6967153.395	+6	496215.158	6967154.430
ERGLENORE STREET MITCHELTON					
ERKARRABIN STREET MITCHELTON					
P	27082 21	496190.849		6967166.240100081	RB1747 S 1.5
PC+5	496166.539	6967178.051	+6	496188.183	6967174.312
PC+6	496188.081	6967173.721	+6	496192.023	6967173.040
PC+6	496192.125	6967173.632	+6	496217.712	6967169.212
PC+5	496215.158	6967154.430	+6	496202.705	6967156.581
PC+6	496184.475	6967159.731	+6	496166.430	6967162.848
PC+6	496163.986	6967163.270			
ERKARRABIN STREET MITCHELTON					
P	27082 22	496136.547		6967151.773100000	LB1747 S 1.5
PC+0	496130.155	6967169.114	+6	496137.311	6967167.878
PC+6	496148.385	6967165.965	+0	496142.940	6967134.432
PC+0	496124.709	6967137.581			
ELRP160610	901771S			592.00	FH 1
P	27082 23	496154.685		6967148.640100000	LB1747 S 1.5
PC+0	496148.385	6967165.965	+6	496163.986	6967163.270
PC+6	496166.430	6967162.848	+0	496160.985	6967131.314
PC+0	496142.940	6967134.432			
ELRP160610	911771S			586.00	FH 1
P	27082 24	496209.205		6967139.222100000	LB1747 S 1.5
PC+0	496202.705	6967156.581	+6	496215.158	6967154.430
PC+6	496221.151	6967153.395	+0	496215.706	6967121.862
PC+0	496197.260	6967125.048			
ELRP160610	941771S			599.00	FH 1
P	27082 25	496246.559		6967132.769100000	LB1747 S 1.5
PC+0	496239.904	6967150.156	+6	496241.833	6967149.823
PC+6	496258.658	6967146.917	+0	496253.213	6967115.383
PC+0	496234.459	6967118.622			
ELRP160610	961771S			609.00	FH 1
P	27082 26	496227.805		6967136.009100000	LB1747 S 1.5
PC+0	496221.151	6967153.395	+6	496239.904	6967150.156
PC+0	496234.459	6967118.622	+0	496215.706	6967121.862
ELRP160610	951771S			609.00	FH 1
P	27082 27	496190.868		6967142.389100000	LB1747 S 1.5
PC+0	496184.475	6967159.731	+6	496202.705	6967156.581
PC+0	496197.260	6967125.048	+0	496179.030	6967128.197
ELRP160610	931771S			592.00	FH 1
P	27082 28	496172.730		6967145.523100000	LB1747 S 1.5
PC+0	496166.430	6967162.848	+6	496184.475	6967159.731
PC+0	496179.030	6967128.197	+0	496160.985	6967131.314
ELRP160610	921771S			586.00	FH 1
P	27082 29	496265.081		6967129.570100000	LB1747 S 1.5
PC+0	496258.658	6967146.917	+6	496276.949	6967143.757
PC+0	496271.504	6967112.223	+0	496253.213	6967115.383
ELRP160610	971771S			594.00	FH 1
*EOF	158				

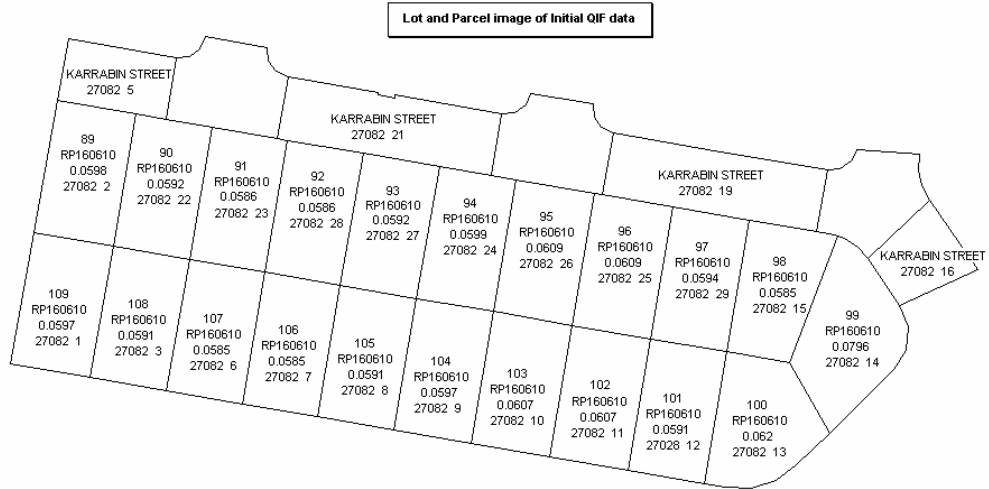

This data extraction is an example of initial QIF data over one segment and may not contain all cases as detailed in the specifications.

### 7.3 Sample of Update QIF

THIS DATA SET IS AN EXTRACT FROM QUEENSLAND'S DIGITAL CADASTRAL DATABASE.  
USE OF THIS DATA SET MAY BE APPROVED WITH THE WRITTEN PERMISSION OF THE  
DIRECTOR GENERAL, DEPARTMENT OF NATURAL RESOURCES AND WATER,  
LOCKED BAG 40, COORPAROO DELIVERY CENTRE, 4151, QUEENSLAND, AUSTRALIA.  
COPYRIGHT, QUEENSLAND, DEPARTMENT OF NATURAL RESOURCES AND WATER, 2006.  
NO LIABILITY ACCEPTED FOR ANY LOSS OR DAMAGE THAT MAY ARISE FROM THE USE OF OR  
RELIANCE ON THIS DATA. DATA CONFORMS TO SPECIFICATION PBD/801/206 VER.3.21.  
UPDATE DATA FOR CLIENT QIFTEST UPDATE DATA LAST SUPPLIED 01/07/1998  
DATA IN MGA94 ON GDA94 EXTRACTED 28/02/2002 12:54

MGA94 56	496111.377	6967090.329	496314.906	6967187.579
SH	496213.142	6967138.954199910291139		1279033
SX	496111.377	6967090.329	496314.906	6967187.579
OP	27082 5	496125.916	6967177.452100081	RB1747 S 1.5
OC+5	496137.311	6967167.878	+6	496130.155 6967169.114
OC+6	496111.377	6967172.358	+6	496113.986 6967187.129
OC+6	496139.864	6967182.659		
ORKARRABIN STREET		MITCHELTON		
OP	27082 7	496167.285	6967113.989100000	LB1747 S 1.5
OC+0	496173.585	6967096.665	+6	496155.540 6967099.782
OC+0	496160.985	6967131.314	+0	496179.030 6967128.197
OLRP160610	1061771S	585.00		FH 1
OP	27082 8	496185.422	6967110.856100000	LB1747 S 1.5
OC+0	496191.815	6967093.516	+6	496173.585 6967096.665
OC+0	496179.030	6967128.197	+0	496197.260 6967125.048
OLRP160610	1051771S	591.00		FH 1
OP	27082 14	496300.677	6967116.346100000	LB1747 S 1.5
OC+0	496298.006	6967139.827	+6	496299.552 6967139.342
OC+6	496302.748	6967137.293	+6	496305.294 6967134.476
OC+6	496312.909	6967123.390	+6	496314.906 6967118.236
OC+6	496314.379	6967112.734	+6	496311.442 6967108.052
OC+6	496296.033	6967092.865	+0	496286.449 6967109.642
OLRP160610	991771S	769.00		FH 1
OP	27082 18	496151.925	6967175.424100082	IB1747 S 1.5
OC+5	496139.864	6967182.659	+6	496142.976 6967182.942
OC+6	496145.528	6967184.743	+6	496146.839 6967187.579
OC+5	496161.620	6967185.025	+6	496161.903 6967181.914
OC+6	496163.704	6967179.361	+6	496166.539 6967178.051
OC+5	496163.986	6967163.270	+6	496148.385 6967165.965
OC+6	496137.311	6967167.878		
ORKARRABIN STREET		MITCHELTON		
ORKENTVILLE STREET		MITCHELTON		
OP	27082 19	496268.696	6967152.794100081	RB1747 S 1.5
OC+5	496244.386	6967164.604	+6	496269.973 6967160.184
OC+6	496295.559	6967155.764	+5	496293.005 6967140.983
OC+6	496276.949	6967143.757	+6	496258.658 6967146.917
OC+6	496241.833	6967149.823		
ORKARRABIN STREET		MITCHELTON		
OP	27082 20	496229.772	6967161.977100082	IB1747 S 1.5
OC+5	496217.712	6967169.212	+6	496220.823 6967169.495
OC+6	496223.375	6967171.296	+6	496224.686 6967174.131
OC+5	496239.467	6967171.578	+6	496239.750 6967168.467
OC+6	496241.550	6967165.914	+6	496244.386 6967164.604
OC+5	496241.833	6967149.823	+6	496239.904 6967150.156
OC+6	496221.151	6967153.395	+6	496215.158 6967154.430
ORGLLENORE STREET		MITCHELTON		
ORKARRABIN STREET		MITCHELTON		
OP	27082 21	496190.849	6967166.240100081	RB1747 S 1.5
OC+5	496166.539	6967178.051	+6	496188.183 6967174.312
OC+6	496188.081	6967173.721	+6	496192.023 6967173.040
OC+6	496192.125	6967173.632	+6	496217.712 6967169.212
OC+5	496215.158	6967154.430	+6	496202.705 6967156.581
OC+6	496184.475	6967159.731	+6	496166.430 6967162.848
OC+6	496163.986	6967163.270		
ORKARRABIN STREET		MITCHELTON		
OP	27082 22	496136.547	6967151.773100000	LB1747 S 1.5
OC+0	496130.155	6967169.114	+6	496137.311 6967167.878
OC+6	496148.385	6967165.965	+0	496142.940 6967134.432
OC+0	496124.709	6967137.581		
OLRP160610	901771S	592.00		FH 1
OP	27082 23	496154.685	6967148.640100000	LB1747 S 1.5
OC+0	496148.385	6967165.965	+6	496163.986 6967163.270
OC+6	496166.430	6967162.848	+0	496160.985 6967131.314
OC+0	496142.940	6967134.432		
OLRP160610	911771S	586.00		FH 1
OP	27082 24	496209.205	6967139.222100000	LB1747 S 1.5
OC+0	496202.705	6967156.581	+6	496215.158 6967154.430
OC+6	496221.151	6967153.395	+0	496215.706 6967121.862
OC+0	496197.260	6967125.048		
OLRP160610	941771S	599.00		FH 1
OP	27082 25	496246.559	6967132.769100000	LB1747 S 1.5
OC+0	496239.904	6967150.156	+6	496241.833 6967149.823
OC+6	496258.658	6967146.917	+0	496253.213 6967115.383
OC+0	496234.459	6967118.622		

Department of Natural Resources and Water Land Information and Titles  
Specification – Queensland Interchange Format ( QIF )

PBD/801/206

Issue: 3.26

Page 31 of 38

OLRP160610	961771S	609.00		FH	1	
OP	27082 27	496190.868	6967142.389100000	LB1747 S	1.5	
OC+0	496184.475	6967159.731	+6	496202.705		6967156.581
OC+0	496197.260	6967125.048	+0	496179.030		6967128.197
OLRP160610	931771S	592.00		FH	1	
OP	27082 28	496172.730	6967145.523100000	LB1747 S	1.5	
OC+0	496166.430	6967162.848	+6	496184.475		6967159.731
OC+0	496179.030	6967128.197	+0	496160.985		6967131.314
OLRP160610	921771S	586.00		FH	1	
OP	27082 29	496265.081	6967129.570100000	LB1747 S	1.5	
OC+0	496258.658	6967146.917	+6	496276.949		6967143.757
OC+0	496271.504	6967112.223	+0	496253.213		6967115.383
OLRP160610	971771S	594.00		FH	1	
P	27082 5	496125.916	6967178.688100081	2RB1747 S	1.5	
PC+5	496130.155	6967169.114	+6	496111.377		6967172.358
PC+6	496113.986	6967187.129	+6	496139.864		6967182.659
ERKARRABIN STREET MITCHELTON						
P	27082 7	496167.285	6967113.989100000	2LB1747 S	1.5	
PC+0	496173.585	6967096.665	+6	496155.540		6967099.782
PC+0	496160.985	6967131.314	+0	496172.811		6967129.271
PC+0	496179.030	6967128.197				
ELRP160610	1061771S	585.00		FH	1	
P	27082 8	496185.422	6967110.855100000	2LB1747 S	1.5	
PC+0	496191.815	6967093.516	+6	496173.585		6967096.665
PC+0	496179.030	6967128.197	+0	496185.435		6967127.091
PC+0	496197.260	6967125.048				
ELRP160610	1051771S	591.00		FH	1	
P	27082 14	496300.677	6967116.346100000	1LB1747 S	1.5	
PC+0	496298.006	6967139.827	+6	496299.552		6967139.342
PC+6	496302.748	6967137.293	+6	496305.294		6967134.476
PC+6	496312.909	6967123.390	+6	496314.906		6967118.236
PC+6	496314.379	6967112.734	+6	496311.442		6967108.052
PC+6	496296.033	6967092.865	+0	496286.449		6967109.642
EBBUP27999 1771S FH						
EUBUP27999 11771S FH						
EUBUP27999 21771S FH						
EUBUP27999 31771S FH						
EUBUP27999 41771S FH						
P	27082 18	496144.769	6967175.002100082	3IB1747 S	1.5	
PC+5	496139.864	6967182.659	+6	496142.976		6967182.942
PC+6	496145.528	6967184.743	+6	496146.839		6967187.579
PC+5	496161.620	6967185.025	+6	496161.903		6967181.914
PC+6	496163.704	6967179.361	+6	496166.539		6967178.051
PC+5	496166.430	6967162.848	+6	496148.385		6967165.965
PC+6	496130.155	6967169.114				
ERKARRABIN STREET MITCHELTON						
ERKENTVILLE STREET MITCHELTON						
P	27082 19	496266.767	6967152.794100081	2RB1747 S	1.5	
PC+5	496244.386	6967164.604	+6	496269.973		6967160.184
PC+6	496295.559	6967155.764	+5	496293.005		6967140.983
PC+6	496276.949	6967143.757	+6	496239.904		6967150.156
ERKARRABIN STREET MITCHELTON						
P	27082 20	496232.326	6967162.310100082	2IB1747 S	1.5	
PC+5	496217.712	6967169.212	+6	496220.823		6967169.495
PC+6	496223.375	6967171.296	+6	496224.686		6967174.131
PC+5	496239.467	6967171.578	+6	496239.750		6967168.467
PC+6	496241.550	6967165.914	+6	496244.386		6967164.604
PC+5	496239.904	6967150.156	+6	496221.151		6967153.395
ERGLENORE STREET MITCHELTON						
ERKARRABIN STREET MITCHELTON						
P	27082 21	496193.293	6967165.205100081	3RB1747 S	1.5	
PC+5	496166.539	6967178.051	+6	496188.183		6967174.312
PC+6	496188.081	6967173.721	+6	496192.023		6967173.040
PC+6	496192.125	6967173.632	+6	496217.712		6967169.212
PC+5	496221.151	6967153.395	+6	496202.705		6967156.581
PC+6	496190.880	6967158.624	+6	496178.256		6967160.805
PC+6	496166.430	6967162.848				
ERKARRABIN STREET MITCHELTON						
P	27082 22	496136.547	6967151.773100000	2LB1747 S	1.5	
PC+0	496130.155	6967169.114	+6	496148.385		6967165.965
PC+0	496142.940	6967134.432	+0	496124.709		6967137.581
ELRP160610	901771S	592.00		FH	1	
P	27082 23	496154.685	6967148.640100000	2LB1747 S	1.5	
PC+0	496148.385	6967165.965	+6	496166.430		6967162.848
PC+0	496160.985	6967131.314	+0	496142.940		6967134.432
ELRP160610	911771S	586.00		FH	1	
P	27082 24	496209.205	6967139.222100000	2LB1747 S	1.5	
PC+0	496202.705	6967156.581	+6	496221.151		6967153.395
PC+0	496215.706	6967121.862	+0	496197.260		6967125.048
ELRP160610	941771S	599.00		FH	1	
P	27082 30	496255.704	6967131.190100000	4LB1747 S	1.5	
PC+0	496239.904	6967150.156	+6	496276.949		6967143.757
PC+0	496271.504	6967112.223	+0	496253.213		6967115.383
PC+0	496234.459	6967118.622				
ELRP989898	101771S	1200.00		FH	1	

Department of Natural Resources and Water Land Information and Titles  
 Specification – Queensland Interchange Format ( QIF )

PBD/801/206

Issue: 3.26

Page 32 of 38

P	27082 31	496169.620	6967146.059100000	4LB1747 S	1.5
PC+0	496166.430	6967162.848	+6	496178.256	6967160.805
PC+0	496172.811	6967129.271	+0	496160.985	6967131.314
ELRP998888	11771S	384.00		FH 1	
P	27082 32	496181.845	6967143.948100000	4LB1747 S	1.5
PC+0	496178.256	6967160.805	+6	496190.880	6967158.624
PC+0	496185.435	6967127.091	+0	496179.030	6967128.197
PC+0	496172.811	6967129.271			
ELRP998888	21771S	410.00		FH 1	
P	27082 33	496194.070	6967141.836100000	4LB1747 S	1.5
PC+0	496190.880	6967158.624	+6	496202.705	6967156.581
PC+0	496197.260	6967125.048	+0	496185.435	6967127.091
ELRP998888	31771S	384.00		FH 1	
P	27082 34	496217.443	6967137.799100000	4EE1747 S	1.5
PC+0	496219.181	6967153.735	+6	496221.151	6967153.395
PC+0	496215.706	6967121.862	+0	496213.736	6967122.202
ELRP996666	A1771S	64.00		EA 1	
P	27082 35	496211.998	6967106.266100000	4EE1747 S	1.5
PC+0	496210.261	6967090.329	+6	496208.291	6967090.669
PC+0	496213.736	6967122.202	+0	496215.706	6967121.862
ELRP996666	B1771S	64.00		EA 1	
XM+	496137.311	6967167.878	-		
XM+	496163.986	6967163.270	-		
XM-			+	496172.811	6967129.271
XM-			+	496178.256	6967160.805
XM+	496184.475	6967159.731	-		
XM-			+	496185.435	6967127.091
XM-			+	496190.880	6967158.624
XM-			+	496208.291	6967090.669
XM-			+	496213.736	6967122.202
XM+	496215.158	6967154.430	-		
XM-			+	496219.181	6967153.735
XM+	496241.833	6967149.823	-		
XM+	496258.658	6967146.917	-		
*EOF	203				

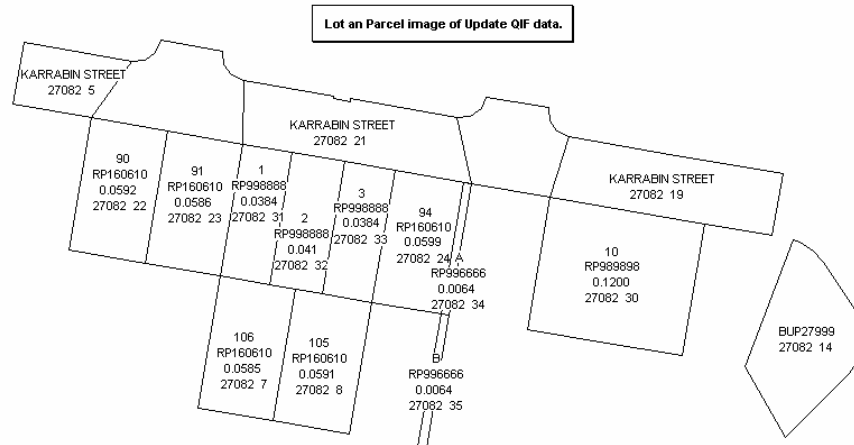

This Update extraction is an example of:

- graphics only or upgraded position update effecting parcels (5, 7, 8, 18, 19, 20, 21, 22, 23, 24);
- an amalgamation with two original parcels (25,29) being amalgamated into one new parcel (30);
- two original parcels (27,28) being subdivided into three new parcels (31,32,33);
- Easements A and B (parcels 34,35) being created;
- and lot (parcel 14) being converted into a Multi-level Building Format Plan record.

The original parcels are those in the initial QIF data in 7.2. This sample QIF file may not contain all examples which may occur in a logical update.

## 7.4 DCDB Tenure Codes

<u>Code</u>	<u>Description</u>
CA	COMMONWEALTH ACQUISITION - Land acquired by the Commonwealth of Australia and held prior to issue of a formal title. (Generally this land is used for military or government store purposes).
CV	COVENANT - A registered right or interest over a parcel of land used to restrict usage of that land (shopping mall tenants).
EA	EASEMENT - A right or interest on a property that is registered against the title.
FD	BELOW THE DEPTH PLANS – A registered right or interest over a parcel of land whose location is defined as below a depth or to a depth below the surface of the earth (Underground Coal mines below Ipswich).
FH	FREEHOLD - Land held in Fee Simple (freehold title) which includes titles surrendered to the State of Queensland (or Crown) in terms of Section 358 of the Land Act 1994.
FR	FOREST RESERVE - Tenure of an interim nature for a maximum of 5 years and managed by the Environmental Protection Agency with associated conditions.
HM	BOAT HARBOURS - Land vested under the control of the Queensland Transport (Maritime Division).
HL	HOUSING LAND - Land vested in the Department of Housing.
ID	INDUSTRIAL ESTATES - Land vested under the control of the Department of State Development, for the development of State Government industrial estates.
LL	LANDS LEASE - Leasehold land administered by the Department of Natural Resources and Water excluding Mining Homestead Tenement Leases.
MT	MINES TENURE - Land leased as Mining Homestead Tenement Leases (eg. MHPL, MHL and SPMPPL) originally issued by the Department of Energy. These leases are now administered by the Department of Natural Resources and Water. This category does not include Mining Lease or Mining Application Areas which can be obtained from the Department of Energy, the exception being ML7024 at Weipa, being land set aside under the "Commonwealth Aluminium Corporation Pty Ltd Agreement Act of 1957" and SBML No.8 under the "Alcan Queensland Pty Limited Agreement Act of 1965" GG1965.2.1441.
MP	MARINE PARK - Land vested under the control of Marine Park Authorities.
MR	MAIN ROAD - Base Parcel – Land vested in the Queensland Transport or the Department of Main Roads prior to issue of title or road dedication. Strata Parcel – Declared Common Area under Transport Infrastructure Act (Main Road over Rail Corridor)
NP	NATIONAL PARK - Land reserved by the Environmental Protection Agency for a National Park, National Park (Scientific), Conservation Park or Resource Reserve.
PH	PORT AND HARBOUR BOARDS - Land vested under the control of Port Authorities.
PP	PROFIT Á PRENDRE - A registered right or interest of use over the property of another that allows the holders to enter and take some natural produce (mineral deposits, timber).
RE	RESERVE - Land reserved by the Department of Natural Resources and Water community or public purposes.
RY	RAILWAY - Land vested for railway purposes in the Queensland Transport or Queensland Rail.
SF	STATE FOREST - Land reserved by the Department of Natural Resources and Water (Resource Management) for State Forest purposes.
SL	STATE LAND - Land held by the State of Queensland as Unallocated State Land and other areas vested in the State (or Crown) but not held in Fee Simple or as a lease issued under the Lands Act 1994.
TR	TIMBER RESERVE - Land reserved by the Department of Natural Resources and Water (Resource Management) for Timber Reserve purposes.
TP	TRANSFERRED PROPERTY - Land transferred to the Commonwealth of Australia on federation, usually for lighthouse or post and telegraph reserves.

WR WATER RESOURCE - Land vested in the Department of Natural Resources and Water (originally Water Resources Commission).

## 7.5 DCDB Positional Accuracy Values

Accuracy Id	Accuracy Display	Accuracy Code	Error in mm	Map Accuracy	Digit Accuracy
0	NO ACCURACY VALUE	X	0		
1	B&D ENTRY CONTROLLED $\pm 0.1M$	B	100		
2	B&D PLOT CONTROLLED $\pm 0.25M$	B	250		
3	B&D PLOT CONTROLLED $\pm 0.3M$	B	300		
4	B&D PLOT CONTROLLED $\pm 0.5M$	B	500		
5	B&D PLOT CONTROLLED $\pm 1M$	B	1000		
6	B&D PLOT CONTROLLED $\pm 1.5M$	B	1500		
7	B&D PLOT CONTROLLED $\pm 2M$	B	2000		
8	B&D PLOT CONTROLLED $\pm 5M$	B	5000		
11	UPGRADE RECTIFICATION $\pm 0.25M$	R	250		
12	UPGRADE RECTIFICATION $\pm 0.5M$	R	500		
13	UPGRADE RECTIFICATION $\pm 1M$	R	1000		
14	UPGRADE RECTIFICATION $\pm 2M$	R	2000		
15	UPGRADE RECTIFICATION $\pm 5M$	R	5000		
16	UPGRADE RECTIFICATION $\pm 10M$	R	10000		
17	UPGRADE RECTIFICATION $\pm 12.5M$	R	12500		
21	UPGRADE PHOTOGRAMMETRY $\pm 1M$	T	1000		
22	UPGRADE PHOTOGRAMMETRY $\pm 1.5M$	T	1500		
23	UPGRADE PHOTOGRAMMETRY $\pm 2M$	T	2000		
24	UPGRADE PHOTOGRAMMETRY $\pm 5M$	T	5000		
25	UPGRADE PHOTOGRAMMETRY $\pm 10M$	T	10000		
26	UPGRADE PHOTOGRAMMETRY $\pm 15M$	T	15000		
27	UPGRADE IMAGERY $\pm 50M$	A	50000		
28	UPGRADE IMAGERY $\pm 25M$	A	25000		
31	STANDARD 1:2500 CADASTRAL MAP $\pm 1.5M$	S	1500	1.25	0.625
32	STANDARD 1:5000 CADASTRAL MAP $\pm 3M$	S	3000	2.5	1.25
33	STANDARD 1:10000 CADASTRAL MAP $\pm 6M$	S	6000	5	2.5
34	STANDARD 1:25000 CADASTRAL MAP $\pm 14M$	S	14000	12.5	6.25
35	STANDARD 1:50000 CADASTRAL MAP $\pm 28M$	S	28000	25	12.5
36	STANDARD 1:100000 CADASTRAL MAP $\pm 56M$	S	56000	50	25
37	STANDARD 1:250000 CADASTRAL MAP $\pm 140M$	S	140000	125	62.5
38	STANDARD 1:2500 ORTHOPHOTO MAP $\pm 1.5M$	O	1500	1.25	0.625
39	STANDARD 1:10000 ORTHOPHOTO MAP $\pm 6M$	O	6000	5	2.5
41	PROVISIONAL 1:2500 CADASTRAL MAP $\pm 7M$	P	7000	6.5	0.625
42	PROVISIONAL 1:10000 CADASTRAL MAP $\pm 25M$	P	25000	25	2.5
43	PROVISIONAL 1:25000 CADASTRAL MAP $\pm 63M$	P	63000	63	6.25
44	PROVISIONAL 1:50000 CADASTRAL MAP $\pm 126M$	P	126000	125	12.5
45	PROVISIONAL 1:100000 CADASTRAL MAP $\pm 251M$	P	251000	250	25
46	PROVISIONAL 1:253440 CADASTRAL MAP $\pm 637M$	P	637000	634	63.4
47	PARISH MAP 1:100000 CONTROL $\pm 57M$	I	57000	50	7.92
50	UPGRADE ADJUSTMENT $\pm 0.25M$	C	250		
51	UPGRADE ADJUSTMENT $\pm 0.5M$	C	500		
52	UPGRADE ADJUSTMENT $\pm 1M$	C	1000		
53	UPGRADE ADJUSTMENT $\pm 2M$	C	2000		
54	UPGRADE ADJUSTMENT $\pm 5M$	C	5000		
55	UPGRADE ADJUSTMENT $\pm 10M$	C	10000		

## 7.6 Example of Parcel Corner Block Record Starting Point

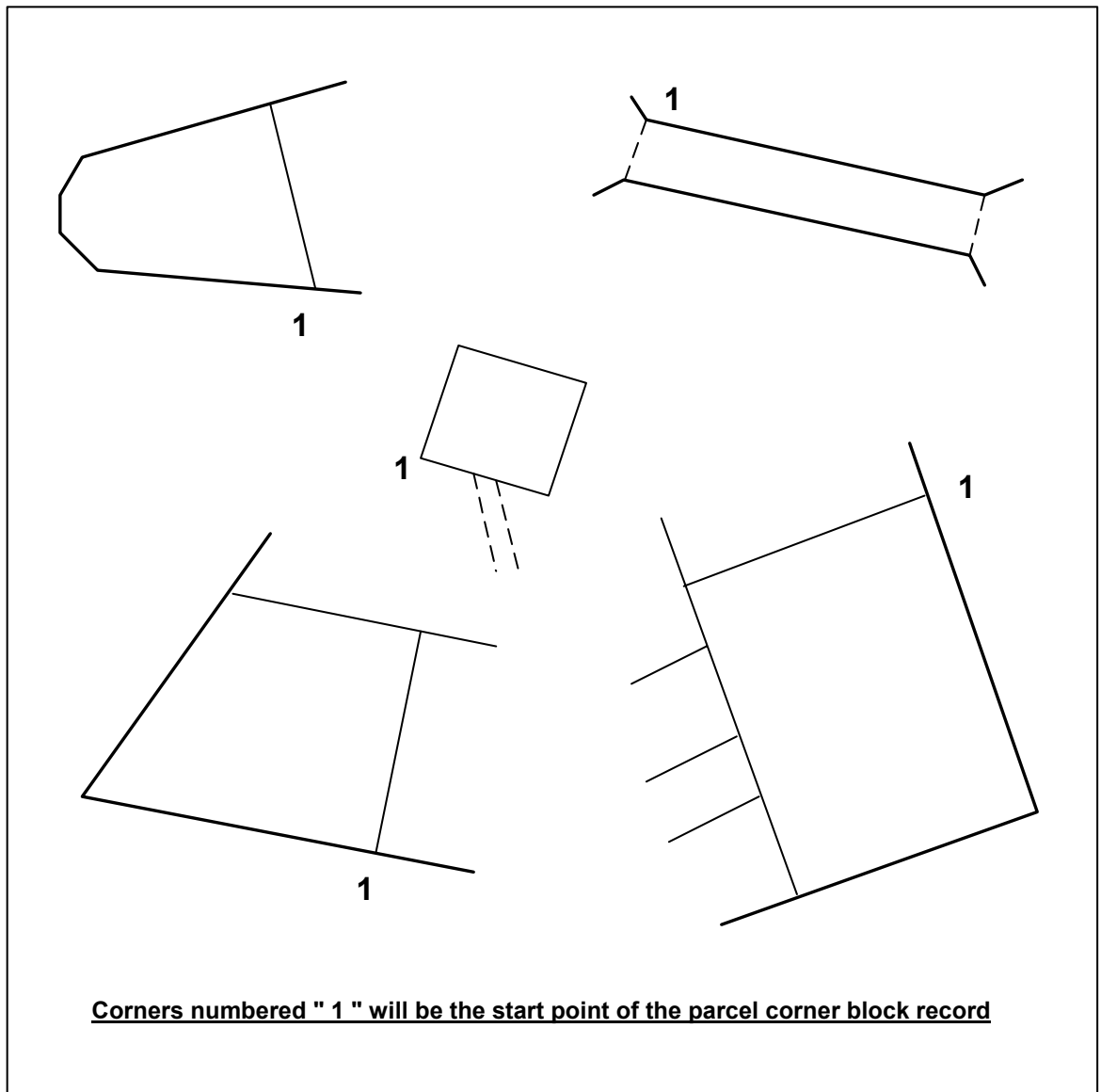

## 7.7 Queensland Local Government Areas

<b>LGA Name</b>	<b>Code</b>		
		Logan City Council	34590
Aurukun Shire Council	30250	Longreach Regional Council	34710
Balonne Shire Council	30300	Mackay Regional Council	34770
Banana Shire Council	30370	McKinlay Shire Council	34800
Barcaldine Regional Council	30410	Mapoon Shire Council	34830
Barcoo Shire Council	30450	Moreton Bay Regional Council	35010
Blackall Tambo Regional Council	30760	Mornington Shire Council	35250
Boulia Shire Council	30900	Mount Isa City Council	35300
Brisbane City Council	31000	Murweh Shire Council	35600
Bulloo Shire Council	31750	Napranum Shire Council	35670
Bundaberg Regional Council	31820	North Burnett Regional Council	35760
Burdekin Shire Council	31900	Northern Peninsula Area Regional Council	35780
Burke Shire Council	31950	Palm Island Shire Council	35790
Cairns Regional Council	32070	Paroo Shire Council	35800
Carpentaria Shire Council	32250	Porpuraaw Shire Council	36070
Cassowary Coast Regional Council	32260	Quilpie Shire Council	36150
Central Highlands Regional Council	32270	Redland City Council	36250
Charters Towers Regional Council	32310	Richmond Shire Council	36300
Cherbourg Shire Council	32330	Rockhampton Regional Council	36360
Cloncurry Shire Council	32450	Roma Regional Council	36410
Cook Shire Council	32500	Scenic Rim Regional Council	36510
Croydon Shire Council	32600	Somerset Regional Council	36580
Dalby Regional Council	32660	South Burnett Regional Council	36630
Diamantina Shire Council	32750	Southern Downs Regional Council	36660
Doomadgee Shire Council	32770	Sunshine Coast Regional Council	36710
Etheridge Shire Council	33100	Tablelands Regional Council	36810
Flinders Shire Council	33200	Toowoomba Regional Council	36910
Fraser Coast Regional Council	33220	Torres Shire Council	36950
Gladstone Regional Council	33360	Torres Strait Island Regional Council	36960
Gold Coast City Council	33430	Townsville City Council	37010
Goondiwindi Regional Council	33610	Weipa Town Council	37300
Gympie Regional Council	33620	Whitsunday Regional Council	37340
Hinchinbrook Shire Council	33800	Winton Shire Council	37400
Hope Vale Shire Council	33830	Woorabinda Shire Council	37550
Ipswich City Council	33960	Wujal Wujal Shire Council	37570
Isaac Regional Council	33980	Yarrabah Shire Council	37600
Kowanyama Shire Council	34420	Unincorporated Qld	39399
Lockhart River Shire Council	34570		
Lockyer Valley Regional Council	34580		

**END OF DOCUMENT**