

MAP 1

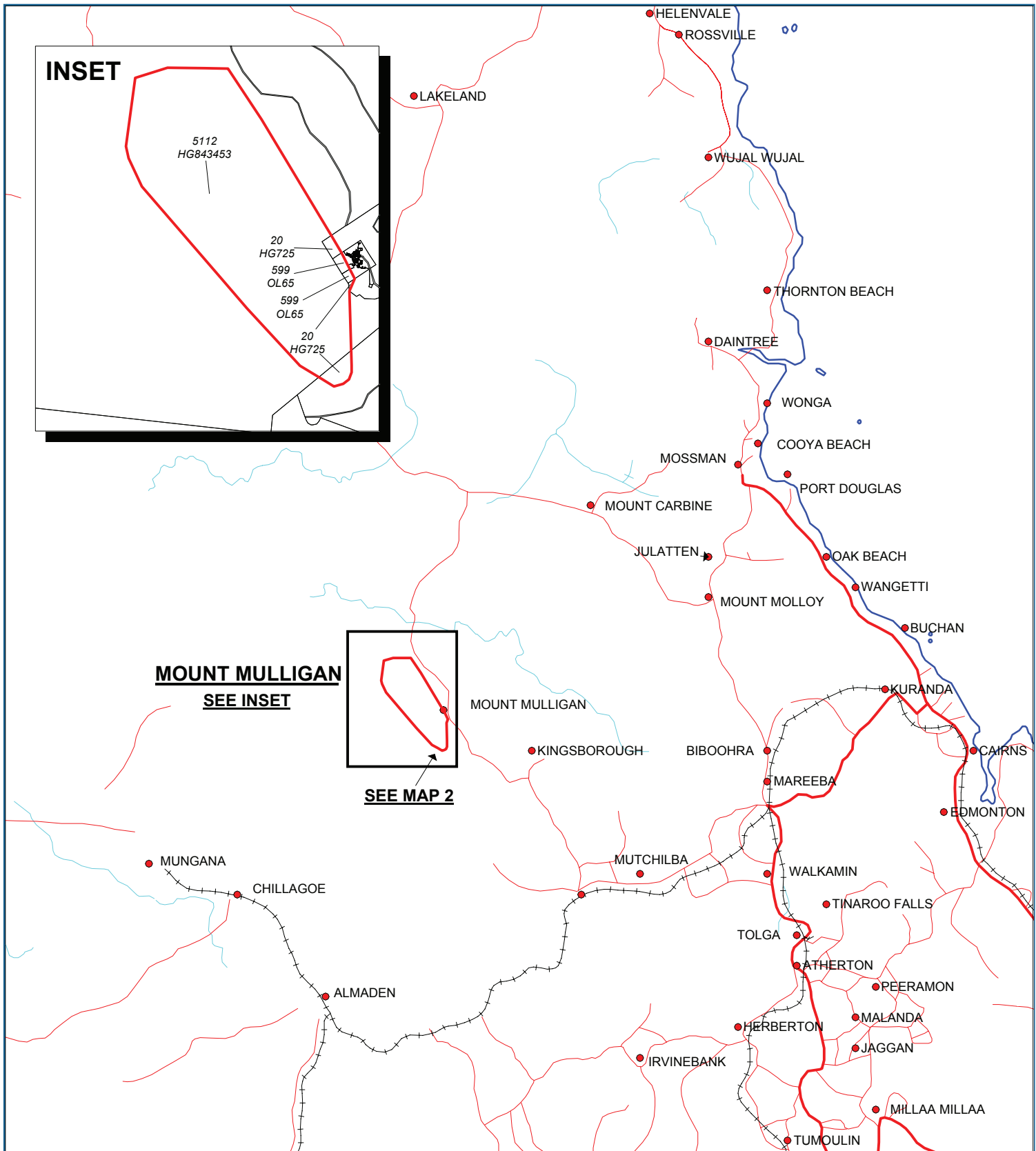

REGISTERED AREA

MOUNT MULLIGAN ABORIGINAL CULTURAL HERITAGE AREA

See "Aboriginal Cultural Heritage Act 2003"
Part 5 Div 2

LOCATION:- 144 °19' 02" -16 °50' 05"

Part of Lot 5112 Plan HG843453,
Lot 20 Plan HG725, and Lot 599 Plan OL65
Tablelands Regional Council



Map Projection : Geographical latitude and longitude GDA94.

Compilation : Land Tenure Information obtained from the Digital Cadastre Data Base Department of Natural Resources and Water Brisbane. The Land Registry in the Department of Natural Resources and Water should be consulted for verification of tenures.

Feature names shown on this map have been obtained from available information. It is possible that errors and omissions may exist.

The Department of Natural Resources and Water disclaims any liability for any errors or omissions that appear in this document.

Copyright protects this publication. Except for purposes permitted by the Copyright Act, reproduction by whatever means is prohibited without the prior written permission of the Department of Natural Resources and Water.

Inquiries should be addressed to the Director-General, Locked Bag 40, Coorparoo Delivery Centre, 4151 QUEENSLAND, AUSTRALIA.

MAP PRODUCED BY CULTURAL HERITAGE COORDINATION UNIT,
DEPARTMENT OF NATURAL RESOURCES AND WATER, BRISBANE.
© THE STATE OF QUEENSLAND (DEPT OF NATURAL RESOURCES AND WATER) 28 JANUARY 2009.

LOCALITY MAP

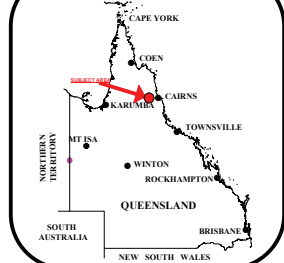

MAP 2

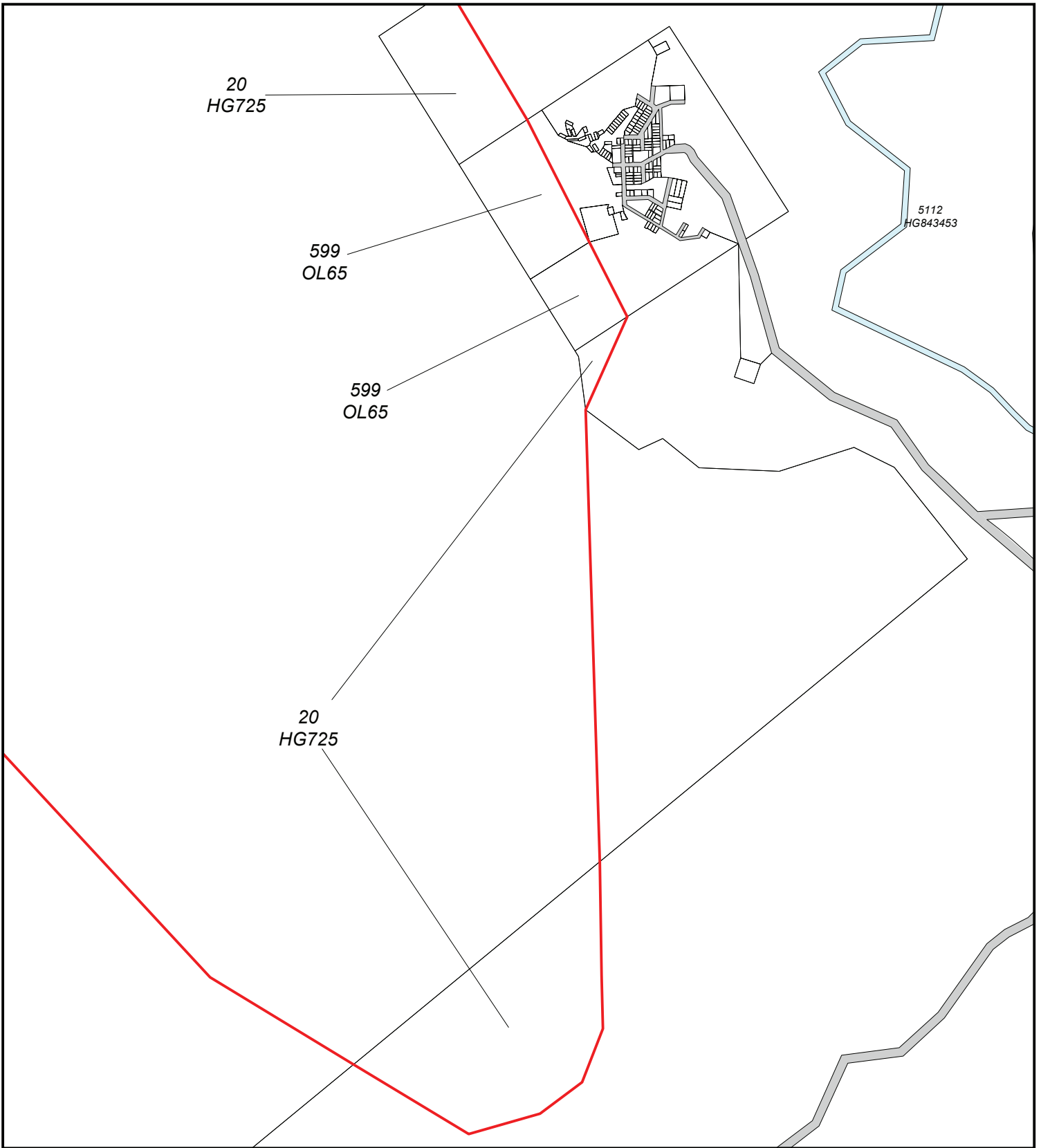

REGISTERED AREA
MOUNT MULLIGAN ABORIGINAL CULTURAL HERITAGE AREA
 See "Aboriginal Cultural Heritage Act 2003"
 Part 5 Div 2
LOCATION:- 144 °19' 02" -16 °50' 05"
 Part of Lot 5112 Plan HG843453,
 Lot 20 Plan HG725, and Lot 599 Plan OL65
 Tablelands Regional Council



Map Projection : Geographical latitude and longitude GDA94.
 Compilation : Land Tenure Information obtained from the Digital Cadastre Data Base Department of Natural Resources and Water Brisbane. The Land Registry in the Department of Natural Resources and Water should be consulted for verification of tenures.
 Feature names shown on this map have been obtained from available information. It is possible that errors and omissions may exist.
 The Department of Natural Resources and Water disclaims any liability for any errors or omissions that appear in this document.
 Copyright protects this publication. Except for purposes permitted by the Copyright Act, reproduction by whatever means is prohibited without the prior written permission of the Department of Natural Resources and Water.
 Inquiries should be addressed to the Director-General, Locked Bag 40, Coorparoo Delivery Centre, 4151 QUEENSLAND, AUSTRALIA.

MAP PRODUCED BY CULTURAL HERITAGE COORDINATION UNIT,
 DEPARTMENT OF NATURAL RESOURCES AND WATER, BRISBANE.
 © THE STATE OF QUEENSLAND (DEPT OF NATURAL RESOURCES AND WATER) 28 JANUARY 2009.

